

CITY OF PALMDALE
GRADING IMPROVEMENT PLAN
APN: 3001-097-012

GRADING GENERAL NOTES

1. ALL WORK SHALL BE DONE IN ACCORDANCE WITH THE EXCAVATION AND BUILDING CODE OF THE CITY OF PALMDALE AND ANY SPECIAL REQUIREMENTS OF THE PERMIT. ANY VIOLATION WILL RESULT IN THE STOPPAGE OF ALL WORK UNTIL THE VIOLATION IS CORRECTED.
2. THE DEVELOPER'S ENGINEER SHALL EXERCISE SUFFICIENT SUPERVISORY CONTROL DURING GRADING AND CONSTRUCTION TO INSURE COMPLIANCE WITH THE APPROVED PLANS AND IN ACCORDANCE WITH SECTION 7020.4, ENGINEERED GRADING REQUIREMENTS, OF THE CITY BUILDING CODE.
3. NO WORK SHALL BE STARTED WITHOUT FIRST SCHEDULING A PRECONSTRUCTION MEETING WITH THE PUBLIC WORKS INSPECTOR. TO SET UP A MEETING CALL (661) 267-5255 AT LEAST 48 HOURS BEFORE WORK IS COMMENCED.
4. SLOPES SHALL BE NO STEEPER THAN 2 HORIZONTAL TO 1 VERTICAL AND 3 HORIZONTAL TO 1 VERTICAL WITHIN LMD DEFINED AREAS, OR AS RECOMMENDED BY THE SOILS ENGINEER AND APPROVED BY THE CITY ENGINEER.
5. FILLS SHALL BE COMPACTED THROUGHOUT TO AT LEAST 90% OF THE MAXIMUM DRY DENSITY AS DETERMINED BY A.S.T.M. SOIL COMPACTION TEST D1557-78.
6. THE DEVELOPER'S SOILS ENGINEER SHALL CERTIFY THAT THE REQUIRED INSPECTIONS AND TESTS HAVE BEEN PERFORMED AND THAT SUCH TESTS COMPLY WITH THE CITY BUILDING CODE.
7. FILL AREAS SHALL BE CLEARED OF ALL VEGETATION AND DEBRIS. SCARIFIED, HAVE SUBDRAINS INSTALLED (IF ANY) AND APPROVED BY THE GRADING INSPECTOR AND SOILS ENGINEER PRIOR TO THE PLACING OF FILL.
8. APPROVED PROTECTIVE MEASURES AND TEMPORARY DRAINAGE PROVISIONS MUST BE USED TO PROTECT ALL IMPACTED PROPERTIES DURING THE GRADING OPERATIONS.
9. DUST SHALL BE CONTROLLED BY WATERING TO THE SATISFACTION OF THE PUBLIC WORKS INSPECTOR/CITY ENGINEER.
10. AFTER ALL WORK, INCLUDING THE INSTALLATION OF DRAINAGE STRUCTURES AND PROTECTIVE DEVICES, HAS BEEN COMPLETED AND REQUIRED REPORTS AND CERTIFICATIONS HAVE BEEN SUBMITTED AND ACCEPTED BY THE CITY, THE PERMITTEE SHALL REQUEST A ROUGH GRADING INSPECTION FROM THE CITY OF PALMDALE ENGINEERING DIVISION.
11. ALL PUBLIC STREETS SHALL BE MAINTAINED FREE OF DUST AND MUD CAUSED BY GRADING OPERATIONS.
12. ALL CESSPOOLS, SEPTIC TANKS, ETC., TO BE ABANDONED SHALL BE FILLED OR REMOVED IN ACCORDANCE WITH THE PLUMBING CODE. CONTACT THE BUILDING & SAFETY DEPARTMENT.
13. ANY EXISTING WELLS TO BE ABANDONED SHALL BE CAPPED IN ACCORDANCE WITH LOS ANGELES COUNTY HEALTH DEPARTMENT REGULATIONS.
14. THE DEVELOPER'S SURVEYOR OR CIVIL ENGINEER OF RECORD SHALL SET GRADE STAKES FOR ALL DRAINAGE DEVICES AND THE CONTRACTOR MUST OBTAIN INSPECTION BEFORE PLACING CONCRETE.
15. NOT LESS THAN ONE FIELD DENSITY TEST WILL BE MADE FOR EACH 2 FEET VERTICAL OF FILL, NOR LESS THAN ONE SUCH TEST FOR EACH 1,000 CUBIC YARDS OF MATERIAL PLACED. LOCATION OF TEST SHALL BE AT THE DISCRETION OF THE PROJECT ENGINEER AND ACCEPTABLE TO THE CITY PUBLIC WORKS INSPECTOR
16. FINISH GRADING WILL BE COMPLETED AND APPROVED, AND SLOPE PLANTING AND IRRIGATION SYSTEMS INSTALLED PER APPROVED PLANS BEFORE FINAL OCCUPANCY IS RELEASED BY THE ENGINEERING DIVISION.
17. ESTIMATED RAW CUT = 162 CUBIC YARDS.
ESTIMATED RAW FILL = 41 CUBIC YARDS.

THESE QUANTITIES ARE RAW NUMBERS ONLY. SEE EARTHWORK BREAKDOWN ON THIS SHEET FOR ESTIMATED LOSSES DUE TO GRUBBING, PROCESSING AND COMPACTION. FOR IMPORT/EXPORT GREATER THAN 50 CUBIC YARDS THE DEVELOPER/GRADING CONTRACTOR SHALL EITHER PROVIDE A HAULING ROUTE DIAGRAM TO THE PUBLIC WORKS INSPECTOR FOR APPROVAL OR OBTAIN A STOCKPILE PERMIT FROM THE CITY PLANNING DEPARTMENT PRIOR TO THE START OF GRADING OPERATION.

18. FIELD DENSITY WILL BE DETERMINED BY THE SAND-CONE METHOD A.S.T.M. D1556-82. IN FINE-GRAINED COHESIVE SOILS, FIELD DENSITY MAY BE DETERMINED BY THE NUCLEAR DENSITY METHOD A.S.T.M. D2922 & D3017 PROVIDED NOT LESS THAN 10% OF THE REQUIRED DENSITY TESTS UNIFORMLY DISTRIBUTED ARE BY THE SAND-CONE METHOD. THE METHOD OF DETERMINING FIELD DENSITY AND LOCATION AND APPROXIMATE ELEVATION SHALL BE SHOWN IN THE COMPACTION REPORT. OTHER METHODS MAY BE USED IF RECOMMENDED BY THE SOILS ENGINEER AND APPROVED IN ADVANCE BY THE CITY ENGINEER.
19. NO ROCK OR SIMILAR MATERIAL GREATER THAN 6" IN DIAMETER WILL BE PLACED IN THE FILL UNLESS RECOMMENDATIONS FOR SUCH PLACEMENT HAVE BEEN SUBMITTED BY THE SOILS ENGINEER IN ADVANCE AND APPROVED BY THE CITY ENGINEER.
20. DENSITY TESTS WILL BE MADE AT POINTS APPROXIMATELY 1 FOOT BELOW THE FILL SLOPE SURFACE ON THE BASIS OF ONE TEST FOR EACH 1,000 SQUARE FEET OF SLOPE SURFACE BUT NOT LESS THAN ONE TEST FOR EACH 10 FEET VERTICAL OF SLOPE HEIGHT.
21. ALL STORM DRAIN WORK IS TO BE DONE UNDER THE SUPERVISORY CONTROL OF THE ENGINEER OF RECORD. WEEKLY STATUS REPORTS SHALL BE SUBMITTED BY THE CONTRACTOR TO THE PUBLIC WORKS INSPECTOR.
22. CONTOURS SHOWN ON PLAN REPRESENT ORIGINAL GROUND ELEVATIONS PRIOR TO GRADING OPERATIONS. CONTOUR INTERVALS SHOWN SHALL BE APPROPRIATE FOR PLANS; HOWEVER, NO INTERVAL SHALL BE GREATER THAN 2 FEET. PROVIDE A LEGEND FOR FINISHED GRADES.
23. EXPECTED DATE FOR START OF GRADING:
EXPECTED DATE FOR COMPLETION OF GRADING:
24. THE UNDERSIGNED CIVIL ENGINEER CERTIFIES THIS GRADING WORK WILL BE SUPERVISED IN ACCORDANCE WITH SECTION 7020.4 ENTITLED "ENGINEERED GRADING REQUIREMENTS", OF THE CITY BUILDING CODE.

25. THE SOILS ENGINEER MUST APPROVE ALL GRADING INCLUDING THE STABILITY OF ANY SLOPES CREATED, EXISTING OR REMAINING.
26. COMPLY WITH ALL REQUIREMENTS OF THE GEOTECHNICAL ENGINEERING REPORT DATED 11/19/2020 PREPARED BY: ENGINEERING SERVICES & DESIGN OF SOCAL INC. (REPORT NO.) J.N. 20-133
27. THE ENGINEER OF RECORD SIGNING THESE PLANS IS RESPONSIBLE FOR

THE ACCURACY AND ACCEPTABILITY OF THE WORK HEREON. IN THE EVENT OF DISCREPANCIES ARISING DURING CONSTRUCTION, THE ENGINEER OF RECORD SHALL BE RESPONSIBLE FOR DETERMINING AN ACCEPTABLE SOLUTION AND REVISING THE PLANS FOR REVIEW AND APPROVAL BY THE CITY.

28. THIS GRADING PLAN HAS BEEN REVIEWED, AND CONFORMS TO RECOMMENDATIONS BY:

NAME OF SOILS ENGINEER SGN. OF SOILS EXP. DATE & STAMP

29. ALL PADS ARE GRADED FLAT AT ROUGH GRADING WITH DRAINAGE SWALES AT A MINIMUM SLOPE OF 1% TOWARDS THE STREET OR AN APPROVED DESIGNED DRAINAGE OUTLET.
30. THE FRONT DRIVE APPROACH FOR RESIDENTIAL LOTS SHALL NOT EXCEED SLOPE OF 14%. APPROACHES FOR COMMERCIAL LOTS SHALL NOT EXCEED 10%.
31. ALL DRYWELLS SHOWN ON THIS PROJECT SHALL BE MAINTAINED BY THE OWNERS WHERE THEIR LOCATIONS ARE ON PRIVATE PROPERTY OR THROUGH THE CREATION OF A LANDSCAPE MAINTENANCE DISTRICT (LMD) WHEN APPROVED BY THE CITY. DRYWELLS WILL BE REPLACED BY THE OWNERS WHEN THEY CEASE TO DRAIN STANDING SURFACE WATER IN A 24 HOUR PERIOD OR ARE DEEMED TO BE OBSOLETE BY THE CITY ENGINEER. REGULAR MAINTENANCE OF THE DRYWELL SETTLING CHAMBER IS REQUIRED TO ACHIEVE PROPER OPERATION OF THE DRYWELL AND SHALL BE PERFORMED ANNUALLY OR MORE OFTEN DEPENDING UPON ITS LOCATION, AND SHALL BE PERFORMED BY THE OWNER OR DISTRICT AS APPLICABLE.
32. ALL DRYWELLS SHALL BE CONSTRUCTED PER CITY OF PALMDALE STANDARDS."
33. TEMPORARY EROSION CONTROL PLANS SHALL BE SUBMITTED PRIOR TO OCTOBER 1. THE CONTROL DEVICES SHOWN ON SAID PLANS SHALL BE INSTALLED PRIOR TO NOVEMBER 1 AND MAINTAINED IN OPERABLE CONDITION UNTIL APRIL 15.
34. THE APPLICANT SHALL SUBMIT TO THE ENGINEERING DIVISION A COPY OF THE PERMIT APPLICATION AND RECEIPT MADE TO THE STATE WATER RESOURCES CONTROL BOARD (SWRCB) AS PROOF THAT A SWPPP HAS BEEN APPROVED.
35. APPROVED EROSION CONTROL PLANS ARE VALID FOR THE YEAR RENEWAL PLAN SHALL BE REQUIRED FOR REVIEW AND APPROVAL BY THE CITY ENGINEER FOR EACH YEAR THEREAFTER UNTIL COMPLETION OF THE PROJECT.
36. IN THE EVENT THE DEVELOPER'S CIVIL ENGINEER, SOILS ENGINEER OR ENGINEERING GEOLOGIST OF RECORD IS CHANGED DURING GRADING THE WORK SHALL BE STOPPED UNTIL A REPLACEMENT HAS BEEN OBTAINED. IT SHALL BE THE DEVELOPER'S RESPONSIBILITY TO NOTIFY THE CITY ENGINEER IN WRITING OF SUCH CHANGE PRIOR TO THE RECOMMENCEMENT OF GRADING OPERATIONS. THE REPLACED ENGINEER SHALL PROVIDE WRITTEN ACCEPTANCE OF ALL WORK PERFORMED TO DATE TO THE CITY ENGINEER.
37. STANDARD HOURS OF OPERATION WITHIN THE CITY ARE 7:00 AM TO 7:00 PM, MONDAY THROUGH FRIDAY. WORK PERFORMED OUTSIDE STANDARD BUSINESS HOURS IS PROHIBITED WITHOUT THE EXPRESSED WRITTEN PERMISSION OF THE CITY ENGINEER.
38. OVERTIME INSPECTION REQUEST ARE GRANTED BASED ON STAFF AVAILABILITY. REQUEST MUST BE RECEIVED 48 HOURS IN ADVANCE AND ADDITIONAL INSPECTION FEES PAID PRIOR TO WORK COMMENCING.
39. ALL UTILITIES SHOWN AS PRIVATE ARE FOR INFORMATION ONLY. REVIEW, APPROVAL AND PERMITTING FOR CONSTRUCTION OF PRIVATE UTILITIES FALLS UNDER THE AUTHORITY OF THE BUILDING OFFICIAL AND OR THE UTILITY PURVEYORS.

CONSTRUCTION NOTES:

- ① CONSTRUCT 6" PCC CURB PER SPWWC 120-2, A1-6 (150), SEE DETAIL 'A' HEREON
- ② CONSTRUCT 4" THICK 2500 PSI PCC CONCRETE WALKWAY PER DETAIL 'B' HEREON
- ③ CONSTRUCT 6" THICK AC PAVEMENT OVER 8" THICK AGGREGATE OVER 95% COMPACTED SUBGRADE
- ④ INSTALL ADA SIGNING AND STRIPING PER BUILDING PLANS
- ⑤ PROPOSED LANDSCAPE
- ⑥ PROPOSED MENU BOARD PER BUILDING PLANS
- ⑦ CONSTRUCT CURB RAMP PER SPWWC 111-5 TYPE 1

CITY OF PALMDALE PERMANENT EROSION CONTROL

- A. THE SURFACE OF ALL SLOPES MORE THAN THREE (3) FEET IN VERTICAL HEIGHT SHALL BE COVERED WITH NORTH AMERICAN GREEN S-150 OR APPROVED EROSION CONTROL BLANKETS. INSTALLATION SHALL CONFORM TO MANUFACTURER'S SPECIFICATIONS.
- B. THE SURFACE OF ALL SLOPES MORE THAN THREE (3) FEET IN VERTICAL HEIGHT SHALL BE PROTECTED AGAINST DAMAGE BY EROSION BY PLANTING WITH GROUND COVER PLANTS. SLOPES EXCEEDING FIFTEEN (15) FEET IN VERTICAL HEIGHT SHALL ALSO BE PLANTED WITH TREES SPACED AT NOT MORE THAN 20 FEET ON CENTER.
- C. SLOPES REQUIRED TO BE PLANTED SHALL BE PROVIDED WITH AN APPROVED SYSTEM OF IRRIGATION.
- D. ALL REQUIRED LANDSCAPING AND IRRIGATION SHALL CONFORM TO THE CITY OF PALMDALE'S SLOPE EROSION CONTROL LANDSCAPING STANDARDS.
- E. ALL PLANTING AND IRRIGATION SHALL BE INSTALLED TO THE SATISFACTION OF THE CITY INSPECTOR PRIOR TO THE ACCEPTANCE OF FINAL GRADING. CONTACT CITY ENGINEERING DIVISION AT (661)267-5255 FOR INSPECTION WITHIN A MINIMUM OF TWENTY-FOUR (24) HOURS NOTICE. FOR LMD CALL FOR LANDSCAPE INSPECTION AT (661) 267-5346.

CITY OF PALMDALE TEMPORARY EROSION CONTROL

- A. THE SURFACE OF ALL SLOPES MORE THAN THREE (3) FEET IN VERTICAL HEIGHT AND STEEPER THAN 5:1 SHALL BE COVERED WITH CITY OF PALMDALE APPROVED EROSION CONTROL BLANKETS. INSTALLATION SHALL CONFORM TO MANUFACTURER'S SPECIFICATIONS. DEVIATIONS FROM THIS REQUIREMENT SHALL BE SUBMITTED IN WRITING WITH AN ALTERNATIVE PLAN FOR TEMPORARY EROSION CONTROL. THIS PLAN SHALL BE APPROVED BY THE CITY ENGINEER.
- B. INSTALLATION OF THE EROSION BLANKETS SHALL BE INSTALLED TO THE SATISFACTION OF THE CITY'S PUBLIC WORKS INSPECTOR PRIOR TO ACCEPTANCE OF ROUGH GRADING AND SHALL BE PER THE MANUFACTURER'S SPECIFICATIONS.

PRIVATE ENGINEER'S NOTICE TO CONTRACTOR

THE EXISTENCE AND LOCATION OF ANY UNDERGROUND UTILITY PIPES, CONDUITS OR STRUCTURES SHOWN ON THESE PLANS WAS OBTAINED BY A SEARCH OF THE AVAILABLE RECORDS. TO THE BEST OF OUR KNOWLEDGE, THERE ARE NO EXISTING UTILITIES EXCEPT AS SHOWN ON THESE PLANS. THE CONTRACTOR IS REQUIRED TO TAKE DUE PRECAUTIONARY MEASURES TO PROTECT THE UTILITY LINES SHOWN ON THESE DRAWINGS. THE CONTRACTOR FURTHER ASSUMES ALL LIABILITY AND RESPONSIBILITY FOR THE UTILITY PIPES, CONDUITS OR STRUCTURES SHOWN OR NOT SHOWN ON THESE DRAWINGS. THE CONTRACTOR SHALL POTHOLE ALL EXISTING UTILITIES TO VERIFY THE LOCATION AND ANY DISCREPANCY BETWEEN THE PLANS SHALL BE BROUGHT TO THE ATTENTION OF THE DESIGN ENGINEER. CONTRACTOR AGREES THAT HE SHALL ASSUME SOLE AND COMPLETE RESPONSIBILITY FOR THE JOB SITE CONDITION DURING THE COURSE OF CONSTRUCTION OF THIS PROJECT, INCLUDING SAFETY OF ALL PERSONS AND PROPERTY AND THAT THIS REQUIREMENT SHALL APPLY CONTINUOUSLY AND NOT BE LIMITED TO NORMAL WORKING HOURS. THE CONTRACTOR ALSO AGREES TO DEFEND, INDEMNIFY AND HOLD THE OWNER AND THE ENGINEER HARMLESS FROM ANY AND ALL LIABILITY, REAL OR ALLEGED IN CONNECTION WITH THE PERFORMANCE OF WORK ON THIS PROJECT, EXCEPTING FOR LIABILITY ARISING FROM THE SOLE NEGLIGENCE OF THE OWNER OR THE ENGINEER.

ENGINEER'S SIGNATURE _____ R.C.E. _____ 2/7/2022
DATE

ZONING AND REGIONAL PLANNING

PROPERTY ZONING: COMMERCIAL
INTENDED LAND USE: COMMERCIAL
(FOR PROPOSED GRADED AREAS)
CERTIFICATE OF COMPLIANCE: CC NO. NA
PLOT PLAN NUMBER: PP NO. NA
CONDITIONAL USE PERMIT: CUP NO. NA EXPIRATION DATE _____
OAK TREE PERMIT NUMBER: OTP NO. NA EXPIRATION DATE _____
COMMUNITY STANDARDS DISTRICT: _____
CALIFORNIA COASTAL COMMISSION AREA: Yes No NA APPROVED VOLUME: _____ (cy)
COASTAL DEVELOPMENT PERMIT CDP: NA EXPIRATION DATE: _____
FISH & GAME, ARMY CORP OF ENGINEERS, REGIONAL WATER CONTROL BOARD, AQMD & OTHER AGENCY PERMITS: NA

PROPERTY INFORMATION

PROPERTY ADDRESS: 3007 RANCHO VISTA BLVD, PALMDALE CA 93550
TRACT / PARCEL MAP NO: 49089 LOT/PARCEL NO: 12
PROPERTY OWNER: RAMI HADDAD
ASSESSORS ID NUMBER: 3001-097-012

GENERAL INFORMATION

GRADING PERMIT APPLICATION NO: EN 21-00305
EARTHWORK VOLUMES FILL: 41 (CY) CUT: 162 (CY)
OVER EXCAVATION/ALLUVIAL REMOVAL & COMPACTION: 691 (CY)
EXPORT NONE, IMPORT: 73 (CY)
TOTAL DISTURBED AREA: 0.162 (AC)
TOTAL PROPOSED LANDSCAPE AREA: 267.86
TOTAL TURF AREA: N/A (PERCENT OF TOTAL PROPOSED LANDSCAPING)
TOTAL DROUGHT TOLERANT LANDSCAPING AREA 100% (PERCENT OF TOTAL PROPOSED LANDSCAPING)
PRE-DEVELOPMENT IMPERVIOUS AREA: 0.226± (AC)
POST-DEVELOPMENT IMPERVIOUS AREA: 0.129± (AC)
WASTE DISCHARGE IDENTIFICATION NUMBER (WDID #) N/A
CONSTRUCTION & DEMOLITION DEBRIS RECYCLING AND REUSE PLAN (RPP ID) N/A
FLOOD ZONE X - AREA OF MINIMAL FLOOD HAZARD.

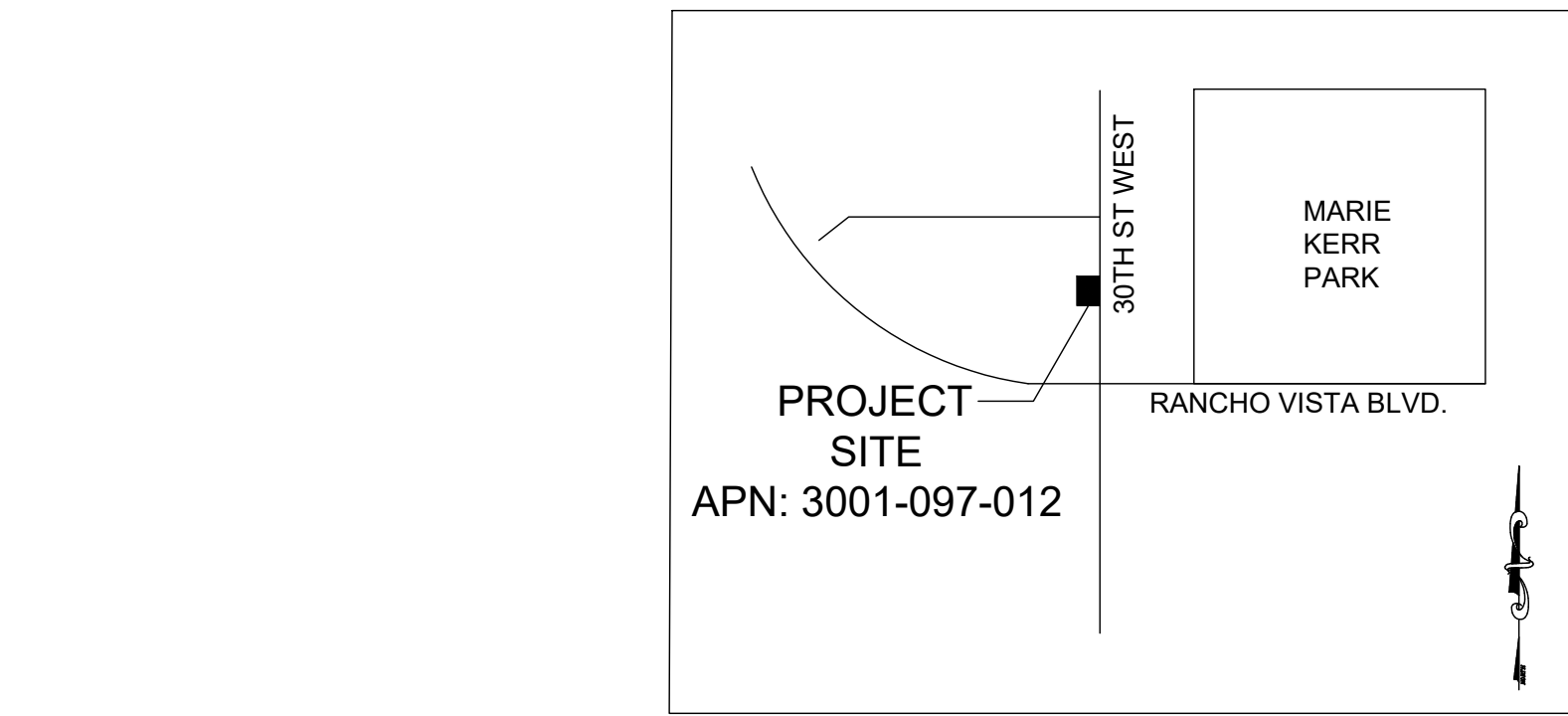

VICINITY MAP

ASSESSOR'S PARCEL NUMBERS:

3001-097-012

SHEET INDEX

SHEET C1.01	COVER SHEET
SHEET C1.02	DEMOLITION PLAN
SHEET C1.03	GRADING PLAN
SHEET C1.04	SITE UTILITY PLAN
SHEET C1.05	HORIZONTAL CONTROL PLAN
SHEET C1.06	SECTIONS
SHEET C1.07	EROSION CONTROL COVER
SHEET C1.08	EROSION CONTROL PLAN

ITEM	A CUT/CUBIC YDS.	B FILL/CUBIC YDS
1. LAND DEVELOPMENT PROGRAM FOR PURE VOLUME (RAW)	162	41
2. SUBSIDENCE LOSS - 0.10'		93
3. OVEREXCAVATION - 4' UNDER BLD PAD 4,667 x 4' / 27	691	691
4. OVEREXCAVATION - ROAD 2,409 X 1' / 27	89	89
5. SUBTOTALS	943	914
6. SHRINKAGE @ 12-17% PER SOILS REPORT (914/0.90) - 914		102
7. TOTALS	943	1016
8. IMPORT		73

GRADING CONTRACTOR TO DETERMINE HIS/HER OWN EARTHWORK QUANTITIES. EARTHWORK VOLUMES ARE LISTED FOR CITY PERMIT PURPOSES ONLY. QUANTITIES SHOWN ARE NOT FOR BIDDING PURPOSES. CONTRACTOR SHOULD NOTE THAT TRUCKED MATERIAL VOLUMES WILL DIFFER FROM THE COMPACTED FILL VOLUME STATED HERE.

NOTES:

- I. QUANTITIES SHOWN HEREON ARE FOR COST ESTIMATE PURPOSES ONLY AND SHALL NOT BE USED FOR BIDDING OR CONSTRUCTION PURPOSES. CONTRACTOR IS REQUIRED TO VERIFY ALL QUANTITIES PRIOR TO COMMENCEMENT OF WORK.
- II. EARTHWORK CALCULATIONS WERE DERIVED FROM UTILIZING AUTOCAD RELEASE 2005 LAND DEVELOPMENT AND CIVIL/SURVEY MODULE. THE GRID METHOD WAS USED WITH A GRID VALUE AND TERRAIN SAMPLING OF 5'X5'.
- III. REMOVAL AND RE-COMPACTION HAS BEEN TAKEN INTO ACCOUNT IN THE QUANTITIES SHOWN ON THIS SHEET.
- IV. SHRINKAGE HAS BEEN TAKEN INTO ACCOUNT ON THIS SHEET.
- V. ALL IMPORTED SOILS MUST BE REVIEWED BY SOILS ENGINEER.

LEGEND

—————	C-BUILDING	
—————	C-CENTERLINE	EXISTING PALM TREE
—————	C-CURB PROPOSED	
—————	C-SWALE	EXISTING MAPLE TREE
—————	C-PROPERTY LINE	
○ — ○ — ○ — ○ — ○	DAYLIGHT LINE	
—————	OVER EX LINE	
————— W ————— W —————	EXISTING WATER LINE	
————— SD ————— SD —————	EXISTING STORM DRAIN	
————— S ————— S —————	EXISTING SEWER LINE	

GRADING PERMIT # EN 21-00305

RECOMMENDED BY: DATE	COMPLIANCE WITH CONDITIONS OF APPROVAL FOR MM 20-045: PLANNING DEPT. DATE	CITY OF PALMDALE COVER SHEET	SHEET C 1.01 Project: 21041	
	ACCEPTED BY CITY ENGINEER: GUILLERMO I. PADILLA RCE 46067 DATE		DESIGNED: AM DRAWN: AM CHECKED: RD SHEET No.	
	CHECKED BY: PLAN CHECK ENGINEER DATE		COMMERCIAL BUILDING GRADING PLAN APN: 3001-097-012 3007 RANCHO VISTA BLVD PALMDALE, CA 93550	1 OF 8
			GD 21-27	

Underground Service Alert

Call: TOLL FREE 811

TWO WORKING DAYS BEFORE YOU DIG

DEVELOPER

RAMI HADDAD
44811 DATE AVE
LANCASTER CA 93534

ENGINEER OF RECORD

44732 YUCCA AVENUE
LANCASTER, CA 93534
(661) 952-7918

Duke Engineering
CIVIL & STRUCTURAL
LANCASTER - CALIFORNIA

NO.	REVISION DESCRIPTION	BY	DATE	APPROVED
▲				
▲				
▲				
▲				
▲				
▲				
▲				

CITY OF PALMDALE
DEMOLITION PLAN

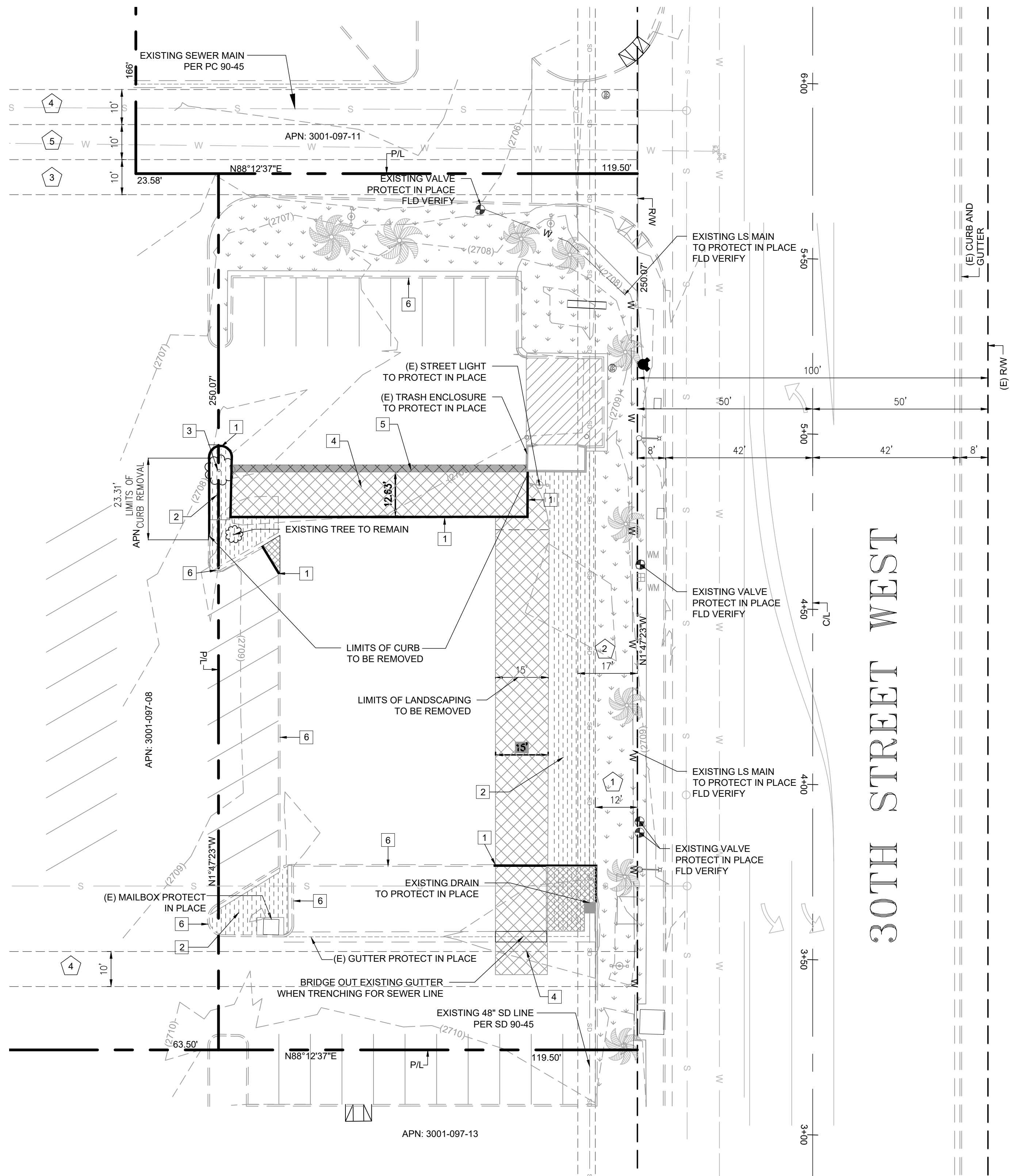

DEMOLITION NOTES

- 1 REMOVE EXISTING CURB
- 2 REMOVE EXISTING LANDSCAPING AND IRRIGATION. LOCATE EXISTING CONTROL WIRES AND PROTECT IN PLACE
- 3 REMOVE EXISTING TREE
- 4 SAWCUT AND REMOVE EXISTING PAVEMENT AND BASE
- 5 SAWCUT 2" MINIMUM EXISTING PAVEMENT FOR A CLEAN JOINT
- 6 EXISTING CURB TO REMAIN IN PLACE

EASEMENTS NOTES

- 1 12 FT EASEMENT FOR LANDSCAPE PURPOSES TO THE CITY OF PALMDALE
- 2 17 FT EASEMENT FOR STORM DRAIN & INGRESS/EGRESS PURPOSES TO THE CITY OF PALMDALE
- 3 10 FT EASEMENT FOR STORM DRAIN & INGRESS/EGRESS PURPOSES TO THE CITY OF PALMDALE
- 4 10 FT EASEMENT FOR SANITARY SEWER PURPOSES TO THE CITY OF PALMDALE
- 5 10 FT EASEMENT FOR WATER LINE & INGRESS/EGRESS PURPOSES TO LA COUNTY WATER WORKS

EXISTING IRRIGATION AND DEMO NOTE:
PROTECT IN PLACE EXISTING VALVES, MAINLINE AND CONTROL WIRES. THE CONTRACTOR IS RESPONSIBLE FOR ANY DAMAGE TO EXISTING IRRIGATION COMPONENTS. PRIOR TO DEMOLITION, CONTACT KEVIN AT AV CENTER MAINTENANCE BY PHONE (661) 947-5794. KEVIN CAN BE CONTACTED VIA EMAIL AT KEVIN@AVCENTERMAINTENANCE.COM TO VERIFY LOCATIONS OF EXISTING IRRIGATION. LOCATE IRRIGATION SHUT OFF PRIOR TO DEMOLITION AND/OR CONSTRUCTION. THE PROVIDED SCHEMATIC OF EXISTING IRRIGATION WAS DONE IN THE FIELD IN SEPTEMBER 2021.

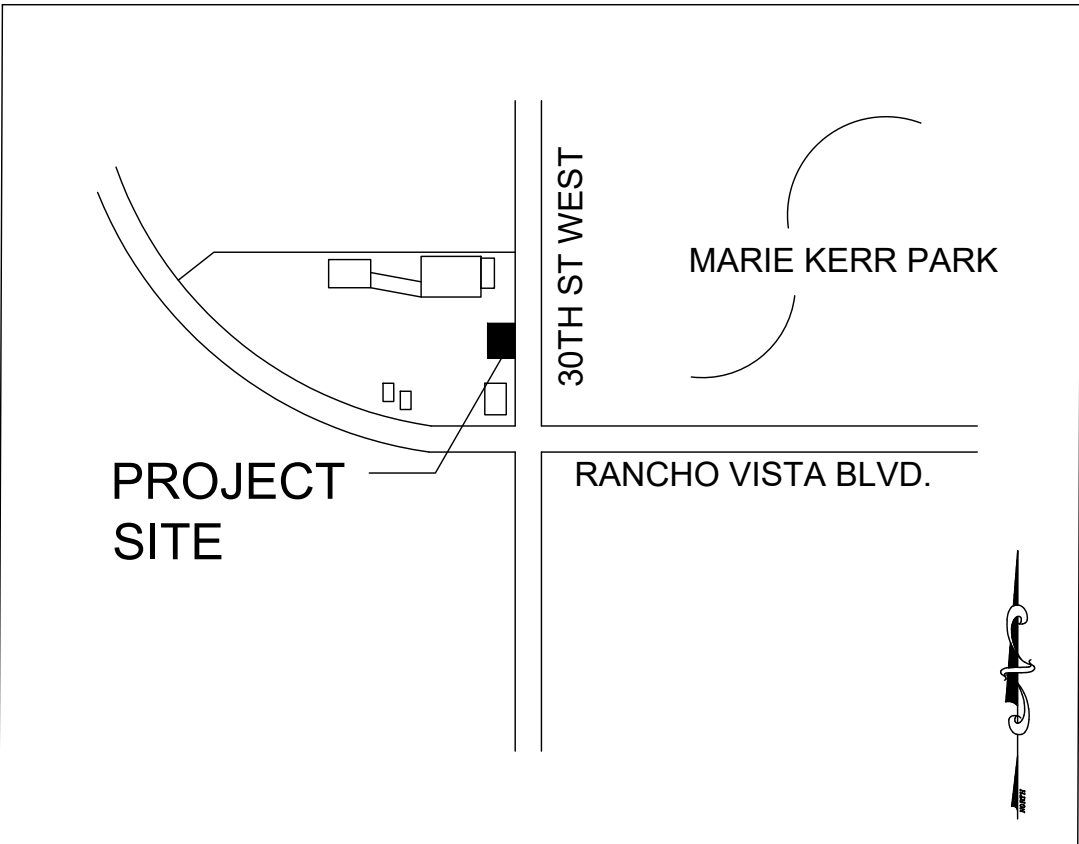

VICINITY MAP
NTS

LEGEND

- LIMITS OF CURB TO BE REMOVED
- AREA OF LANDSCAPE TO BE REMOVED
- AREA TO BE DEMOLISHED
- EXISTING CURB TO REMAIN

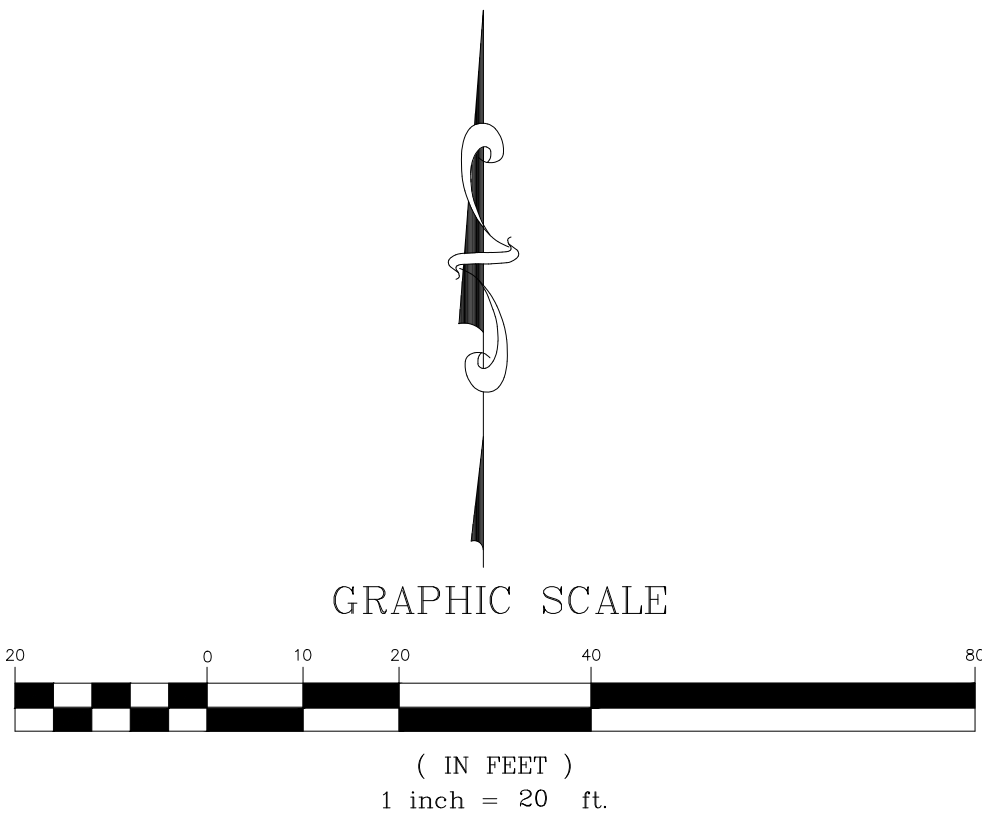

Underground Service Alert
Call: TOLL FREE
811
TWO WORKING DAYS BEFORE YOU DIG

DEVELOPER
RAMI HADDAD
44811 DATE AVE
LANCASTER CA 93534

ENGINEER OF RECORD
44732 YUCCA AVENUE
LANCASTER, CA 93534
(661) 952-7918

LANCASTER - CALIFORNIA

NO.	REVISION DESCRIPTION	BY	DATE	APPROVED

CHECKED BY: _____

PLAN CHECK ENGINEER _____ DATE _____

CITY OF PALMDALE

DEMOLITION PLAN

COMMERCIAL BUILDING GRADING PLAN

APN: 3001-097-012
3007 RANCHO VISTA BLVD
PALMDALE, CA 93550

GD 21-27

SHEET
C 1.02
Project: 21041
DESIGNED: AM
DRAWN: AM
CHECKED: RD
SHEET No.
2 OF 8

GD 21-27

CITY OF PALMDALE GRADING PLAN

EASEMENTS NOTES

- ① — 12 FT EASEMENT FOR LANDSCAPE PURPOSES TO THE CITY OF PALMDALE
- ② — 17 FT EASEMENT FOR STORM DRAIN & INGRESS/EGRESS PURPOSES TO THE CITY OF PALMDALE
- ③ — 10 FT EASEMENT FOR STORM DRAIN & INGRESS/EGRESS PURPOSES TO THE CITY OF PALMDALE
- ④ — 10 FT EASEMENT FOR SANITARY SEWER PURPOSES TO THE CITY OF PALMDALE
- ⑤ — 10 FT EASEMENT FOR WATER LINE & INGRESS/EGRESS PURPOSES TO LA COUNTY WATER WORKS

CONSTRUCTION NOTES:

- ① CONSTRUCT 6" PCC CURB PER SPWWC 120-3, A1-6 (150). SEE DETAIL 'A' HEREON
- ② CONSTRUCT 4" THICK 2500 PSI PCC CONCRETE WALKWAY PER DETAIL 'B' HEREON
- ③ CONSTRUCT 6" THICK AC PAVEMENT OVER 8" THICK AGGREGATE OVER 90% COMPACTED SUBGRADE
- ④ INSTALL ADA SIGNING AND STRIPING PER BUILDING PLANS
- ⑤ PROPOSED LANDSCAPE PER LSP 21-27 COM
- ⑥ PROPOSED MENU BOARD PER BUILDING PLANS
- ⑦ CONSTRUCT CURB RAMP PER DETAILS HEREON
- ⑧ CONSTRUCT 6" PCC CURB AND GUTTER PER SPWWC 120-3, A2-6(150). SEE DETAIL 'C' HEREON

LEGEND

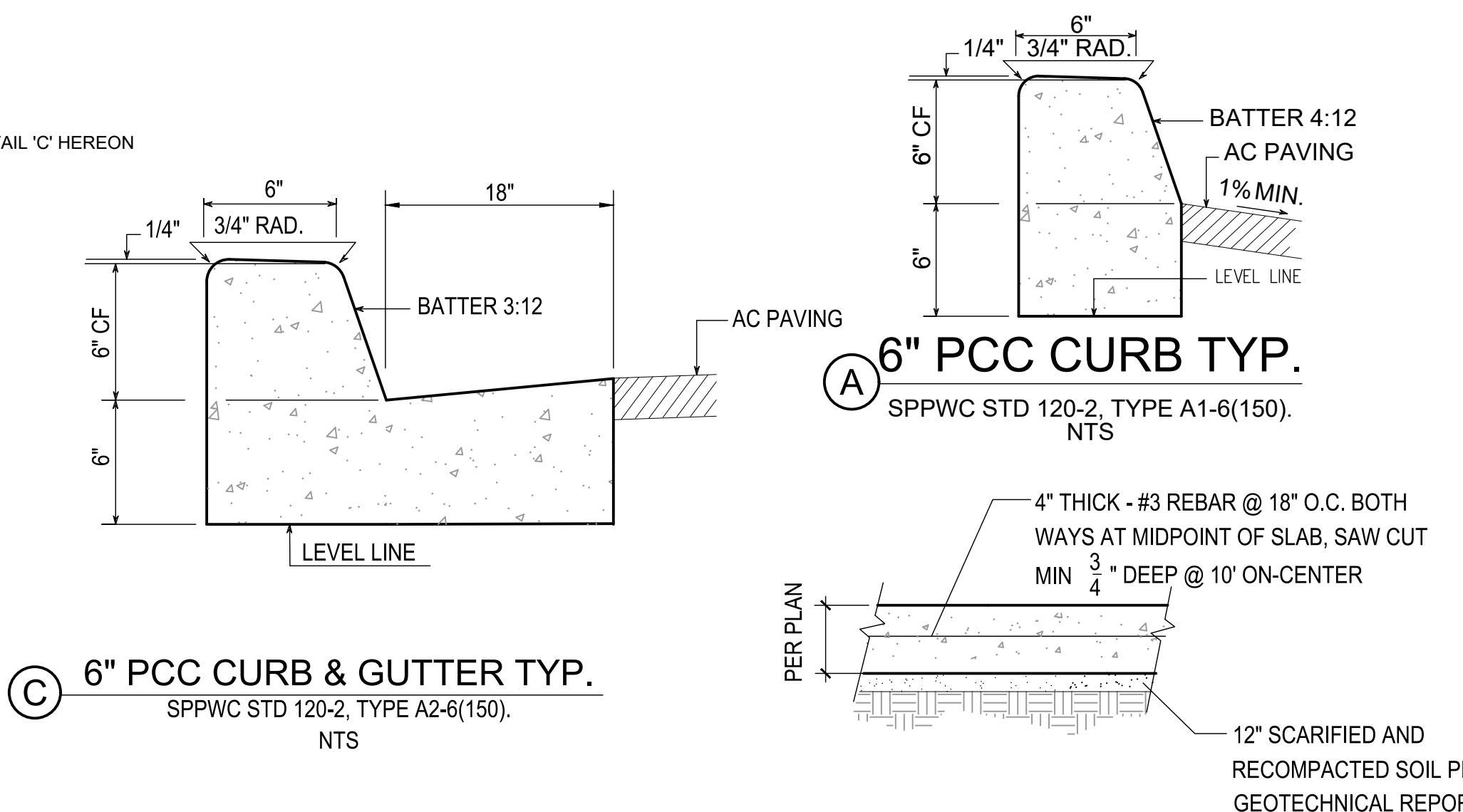
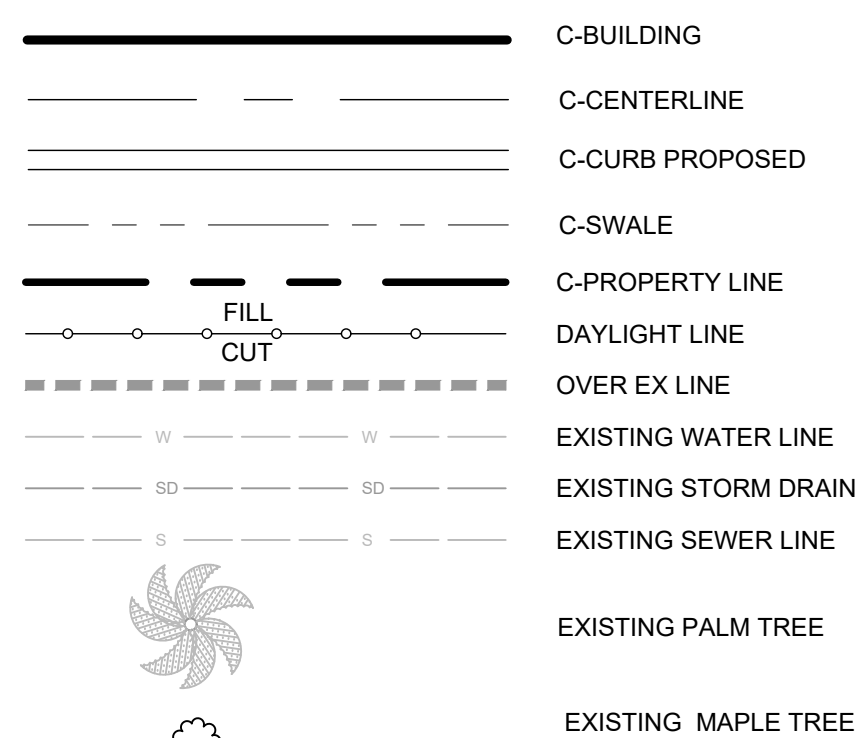

PCC PAVEMENT

NTS

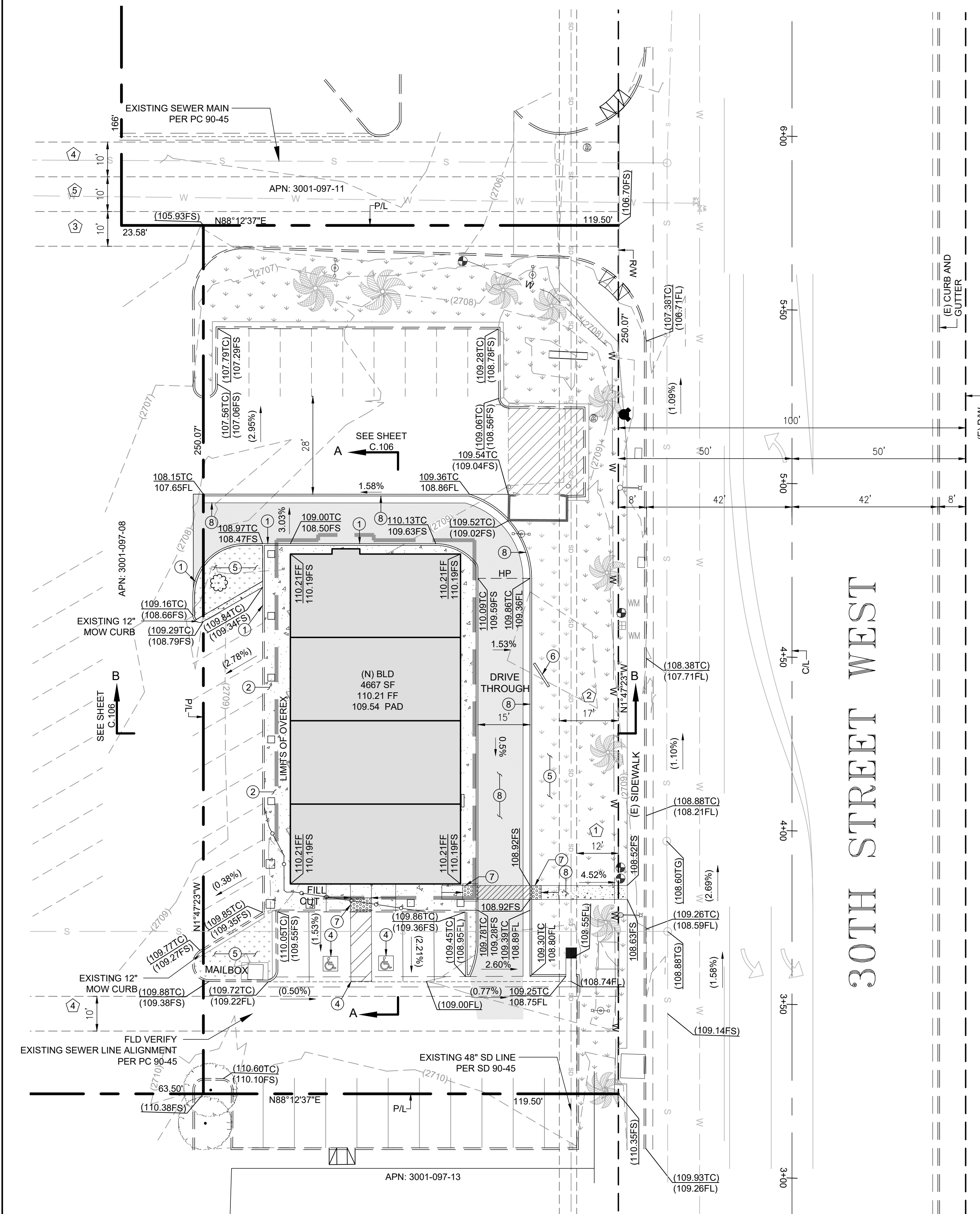

ADA SOUTH CURB RAMP

SPPWC 111-5 TYPE 1 CASE
1:10

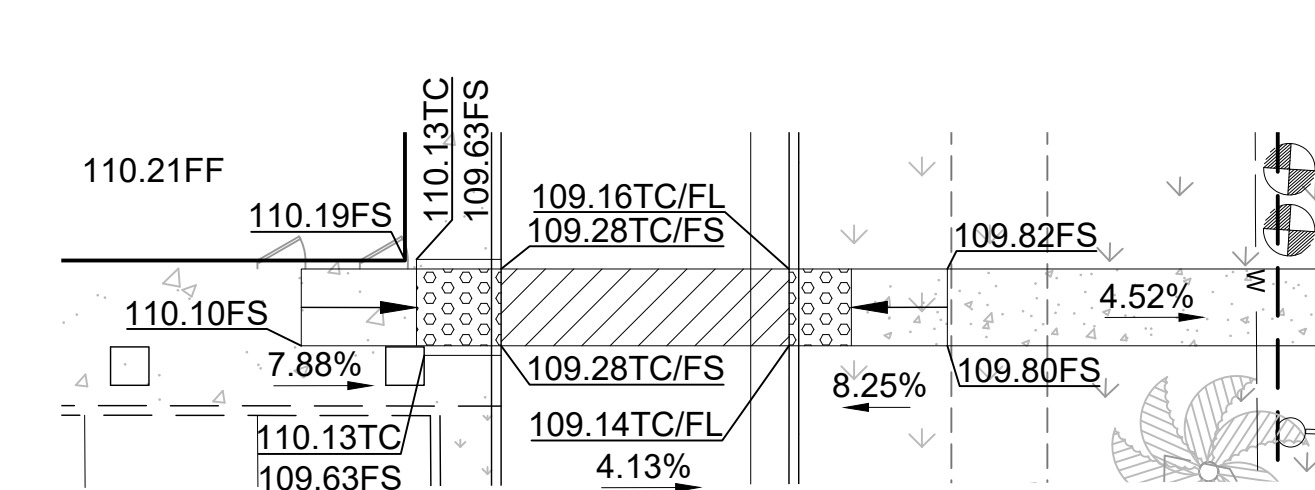

ADA EAST CURB RAMI

SPPWC 111-5 TYPE 1 CASE A
1:10

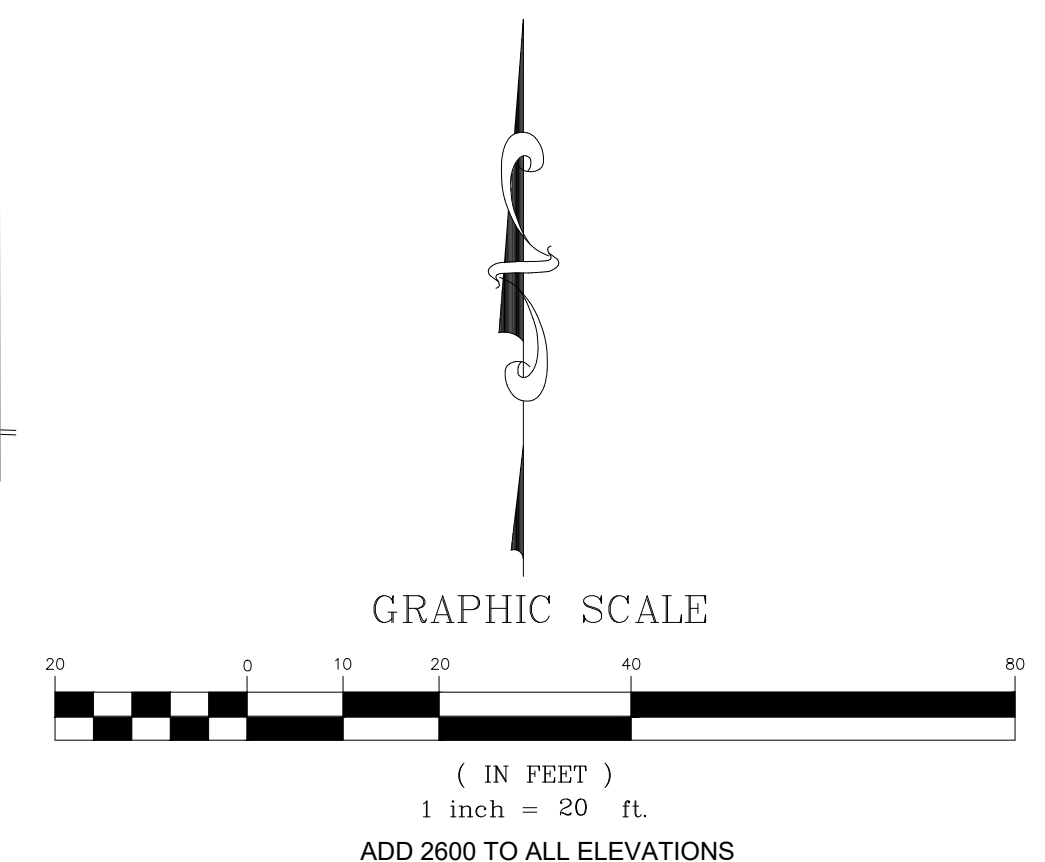

Underground Service Alert

CALL BEFORE YOU DIG

Call: TOLL FREE

811

TWO WORKING DAYS BEFORE YOU DIG

DEVELOPER
RAMI HADDAD
44811 DATE AVE
LANCASTER CA 9353

ENGINEER OF RECORD
44732 YUCCA AVENUE
LANCASTER, CA 93534
(661) 952-7918

[illegible]

CHECKED BY:	
-------------	--

PLAN CHECK ENGINEER	DATE
---------------------	------

CITY OF PALMDALE

GRADING PLAN

COMMERCIAL BUILDING GRADING PLAN

APN: 3001-097-012
3007 RANCHO VISTA BLVD
PALMDALE, CA 93550

SHEET

C 1.03

DESIGNED: AM

DRAWN: AM

CHECKED: RD

3 OF 8

GD 21-27

CITY OF PALMDALE
SITE UTILITY PLAN

ONSITE UTILITY GENERAL NOTES

1. ALL WORK SHALL BE PERFORMED ACCORDING TO THE LATEST EDITION OF THE STANDARD SPECIFICATIONS FOR PUBLIC WORKS CONSTRUCTION.
2. CONTRACTOR SHALL OBTAIN ALL REQUIRED PERMITS FOR WORK IN PUBLIC STREETS.
3. CONTRACTOR SHALL NOTIFY CITY INSPECTOR, ENGINEER AND ANY AFFECTED UTILITIES 48 HOURS BEFORE COMMENCING WORK.
4. CONTRACTOR IS RESPONSIBLE FOR ALL JOB SITE SAFETY AND TRAFFIC CONTROL. CONTRACTOR SHALL COMPLY WITH C.D.P.W. STANDARDS, MINIMUM PUBLIC SAFETY REQUIREMENTS FOR OPEN EXCAVATIONS.
5. CONTRACTOR SHALL PROVIDE FOR DRAINAGE CONTROL IN ALL ASPECTS OF THE WORK. CONTRACTOR SHALL TAKE NECESSARY AND PROPER PRECAUTIONS TO PROTECT ADJACENT PROPERTIES AND HIS WORK. CONTRACTOR IS RESPONSIBLE FOR ALL DAMAGE THAT MAY OCCUR TO PREVIOUSLY FINISHED OR PARTIALLY FINISHED WORK AND/OR ADJACENT PROPERTIES.
6. NO CHANGES SHALL BE MADE TO THESE PLANS WITHOUT THE APPROVAL OF THE PRIVATE ENGINEER.
7. IMPORTANT NOTICE - SECTION 4216/4217 OF THE GOVERNMENT CODE REQUIRES DIG ALERT IDENTIFICATION NUMBER BE ISSUED BEFORE ANY "PERMIT TO EXCAVATE" WILL BE VALID. FOR YOUR DIG ALERT I.D. NUMBER, CALL UNDERGROUND SERVICE ALERT TOLL FREE @ 1-800-422-4133, TWO WORKING DAYS BEFORE YOU DIG.
8. EXISTING UNDERGROUND UTILITIES SHALL BE MAINTAINED IN PLACE, UNLESS OTHERWISE REQUIRED BY UTILITY COMPANY OR NOTED HEREON. ALL EXISTING ABOVE GROUND UTILITIES SHALL BE RELOCATED OR UNDERGROUND PER CITY STANDARDS AND UTILITY COMPANY REQUIREMENTS, AS REQUIRED HEREON.
9. DUST SHALL BE CONTROLLED BY WATERING TO THE SATISFACTION OF THE CITY INSPECTOR. ALL PUBLIC STREETS SHALL BE MAINTAINED FREE OF DUST AND MUD CAUSED BY GRADING OPERATION.
10. ELEVATIONS SHOWN ON DRAWINGS ARE TO FEET ABOVE U.S.C. & G.S. SEA LEVEL DATUM OF 1929, USING ADJUSTMENT SHOWN.
11. CONTRACTOR SHALL VERIFY ALL SITE UTILITY ROUTES, STRUCTURE LOCATIONS, AND ASSOCIATED REQUIREMENTS WITH RESPECTIVE UTILITY COMPANIES BEFORE COMMENCING WORK ON THOSE UTILITIES.
12. ALL TRENCHES SHALL BE BACK FILLED PER SECTION 306-1.3 OF THE STANDARD SPECIFICATIONS AND COMPACTED TO 90% OF MAXIMUM DENSITY PER ASTM D-78. THIS SHALL BE VERIFIED BY A LICENSED GEOTECHNICAL ENGINEER.
13. ALL PIPELINES SHALL BE TESTED FOR LEAKAGE PER SECTION 306-1.4 OF THE STANDARD SPECIFICATION
14. CONTRACTOR SHALL BE RESPONSIBLE FOR PRESERVING ALL GRADE STAKES UNTIL AUTHORIZED BY SURVEYOR TO REMOVE.

UTILITY CONSTRUCTION NOTES

1. CONSTRUCT 1" ASTM D-1785 SCHEDULE 80 PVC DOMESTIC WATER LINE, DEPTH TO BE 3' MIN. FROM FS.
2. CONSTRUCT 6" ASTM D-3034 SDR35 SEWER PIPE WITH RUBBER GASKET JOINTS.
3. CONSTRUCT FIRE WATER LINE
4. CONSTRUCT SEWER CLEANOUT PER DETAIL 'A' HEREON
5. CONSTRUCT 4" ABS SEWER LATERAL
6. PROPOSED SADDLE CONNECTION PER DETAIL 'B' HEREON. WORK TO BE DONE UNDER SEPARATE ENCROACHMENT PERMIT
7. UPGRADE STORM DRAIN FILTER PER BMP STANDARDS

EASEMENTS NOTES

1. 12 FT EASEMENT FOR LANDSCAPE PURPOSES TO THE CITY OF PALMDALE
2. 17 FT EASEMENT FOR STORM DRAIN & INGRESS/EGRESS PURPOSES TO THE CITY OF PALMDALE
3. 10 FT EASEMENT FOR STORM DRAIN & INGRESS/EGRESS PURPOSES TO THE CITY OF PALMDALE
4. 10 FT EASEMENT FOR SANITARY SEWER PURPOSES TO THE CITY OF PALMDALE
5. 10 FT EASEMENT FOR WATER LINE & INGRESS/EGRESS PURPOSES TO LA COUNTY WATER WORKS

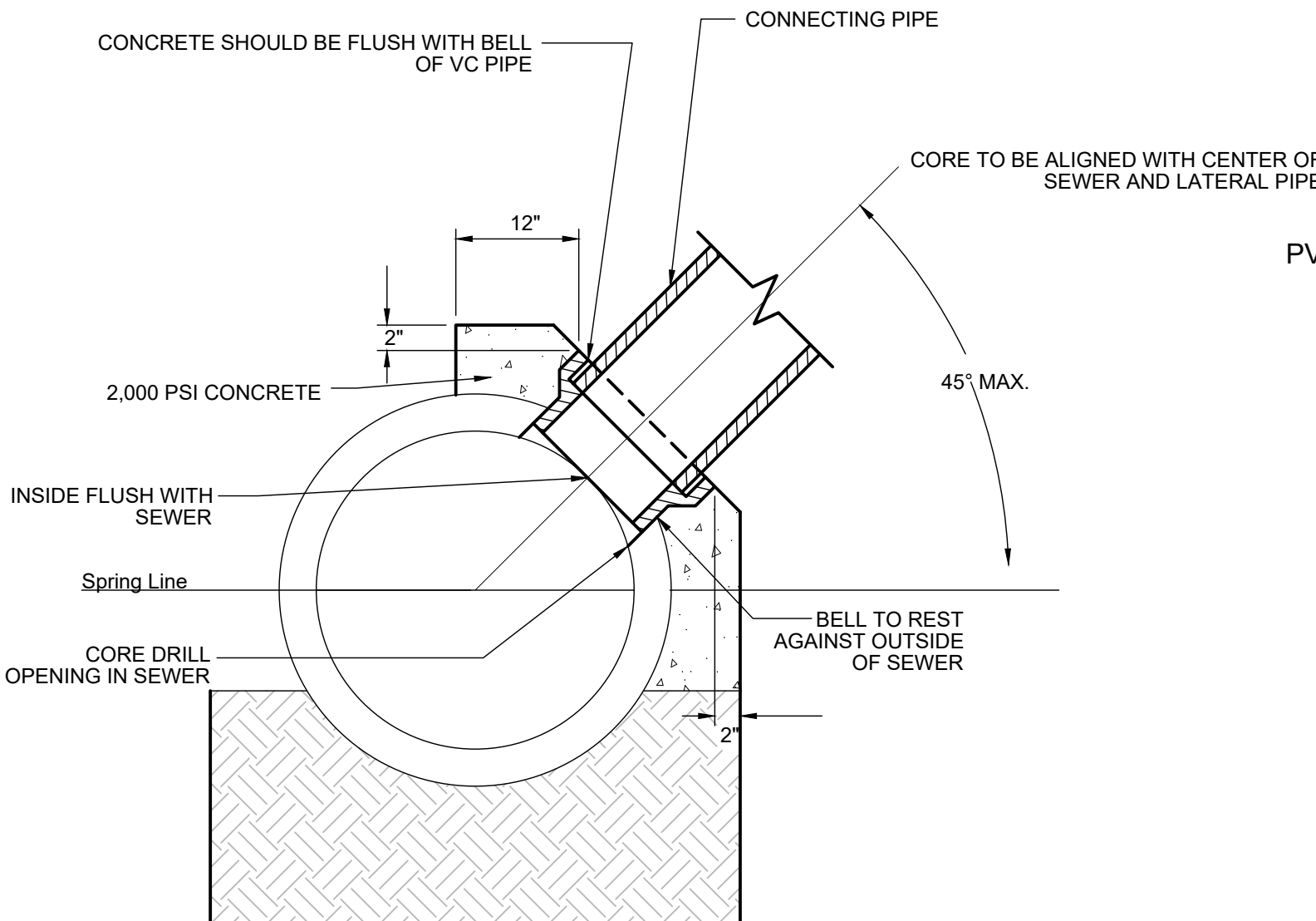

B SADDLE CONNECTION
NTS

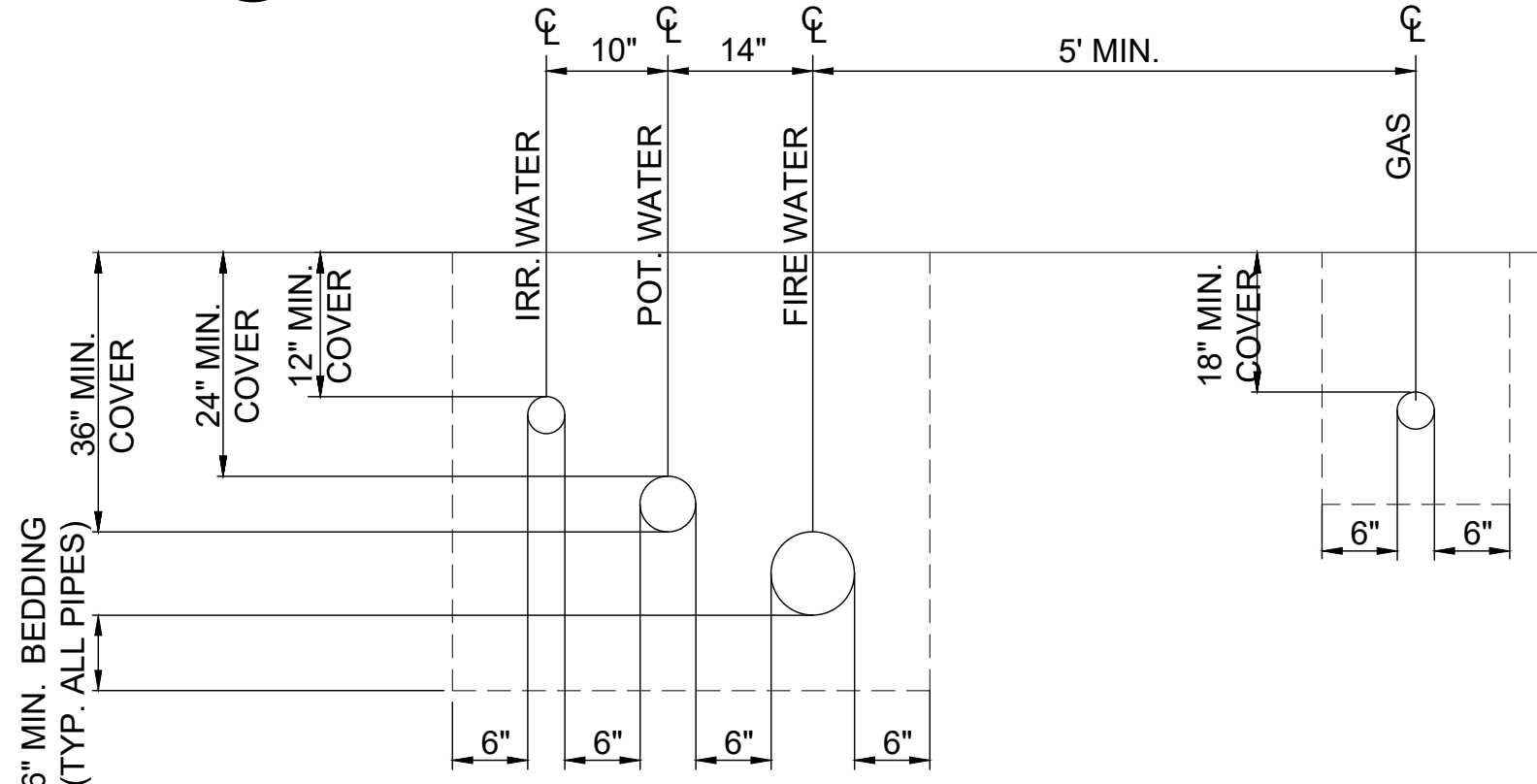

C TYPICAL UTILITY DEPTHS AND CLEARANCES
NTS

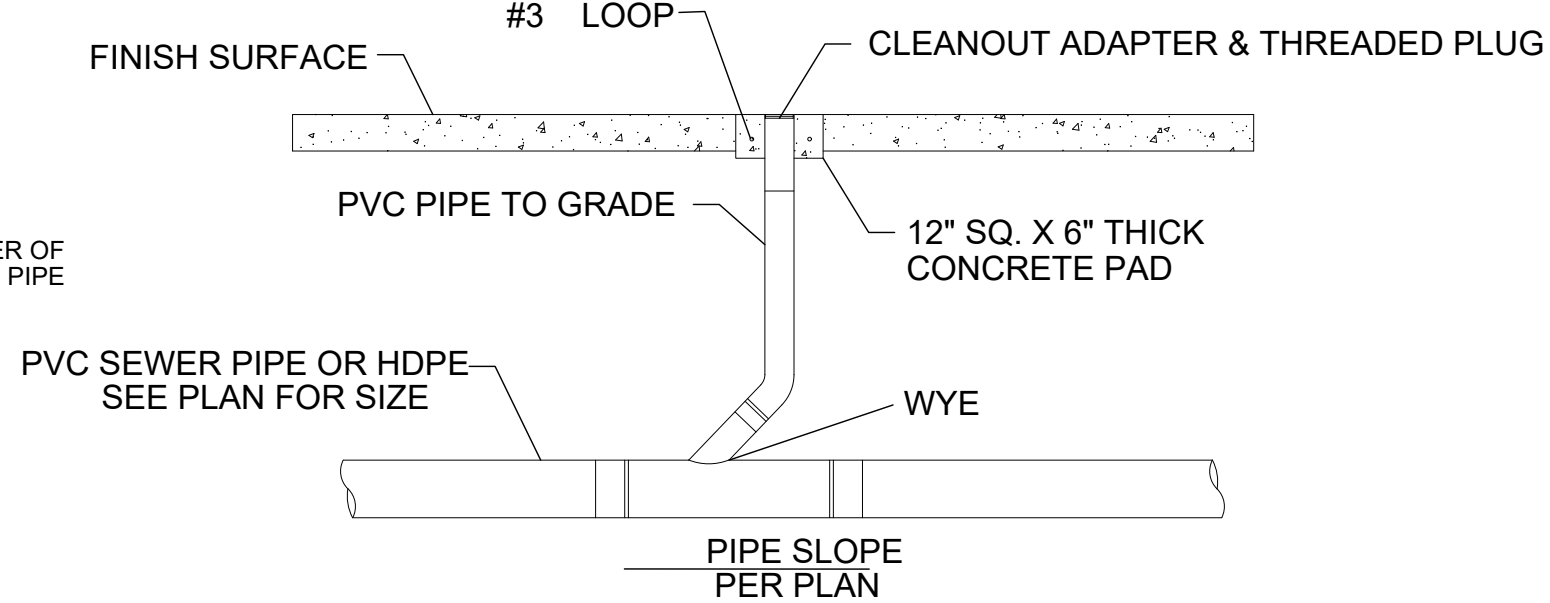

A TYPICAL CLEANOUT DETAIL
SPPWC STD 204-2
SCALE: NTS

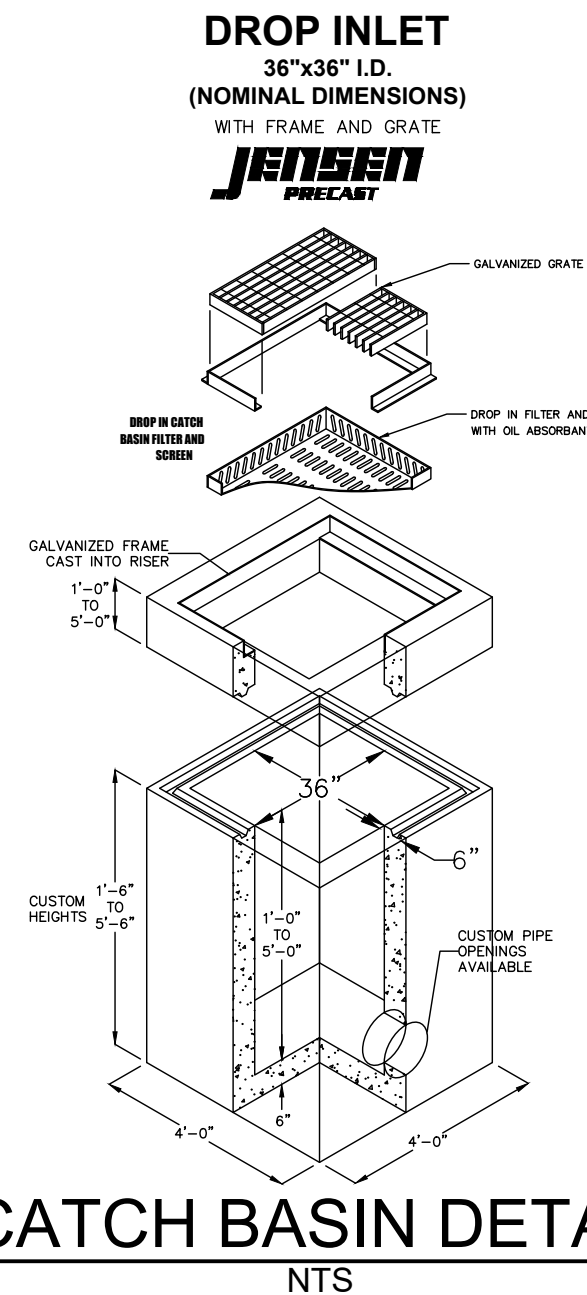

CATCH BASIN DETAIL
NTS

GRAPHIC SCALE

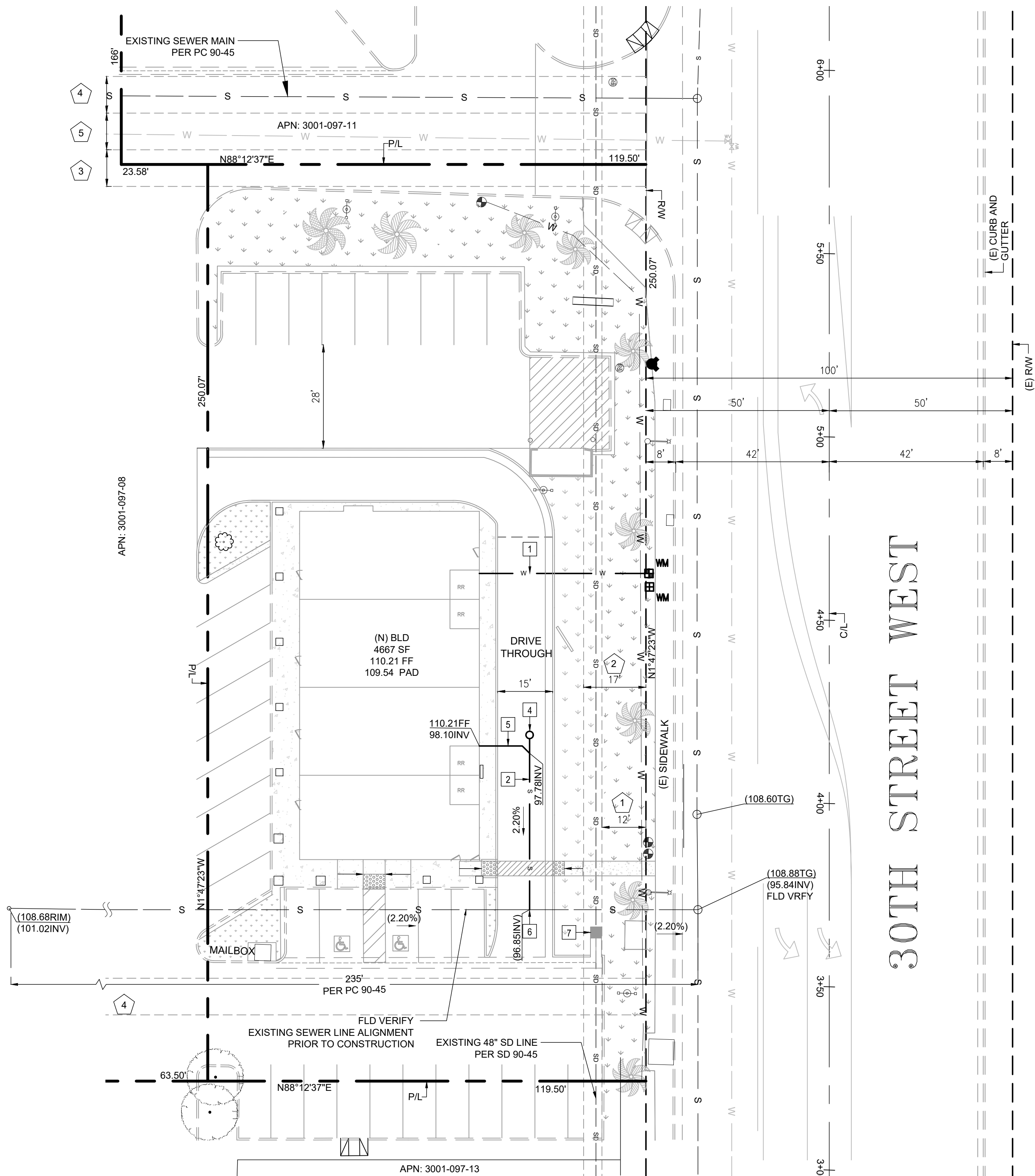
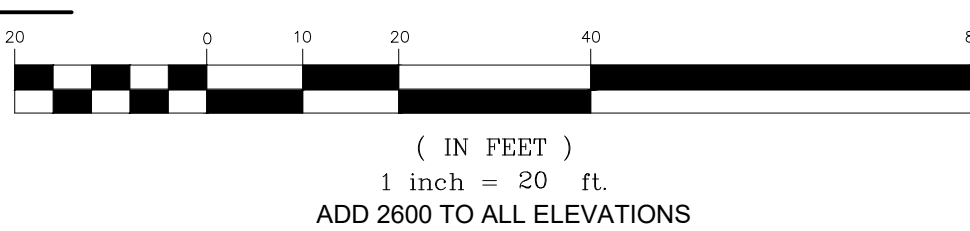

Underground Service Alert

Call: TOLL FREE 811

TWO WORKING DAYS BEFORE YOU DIG

DEVELOPER
RAMI HADDAD
44811 DATE AVE
LANCASTER CA 93534

ENGINEER OF RECORD
44732 YUCCA AVENUE
LANCASTER, CA 93534
(661) 952-7918

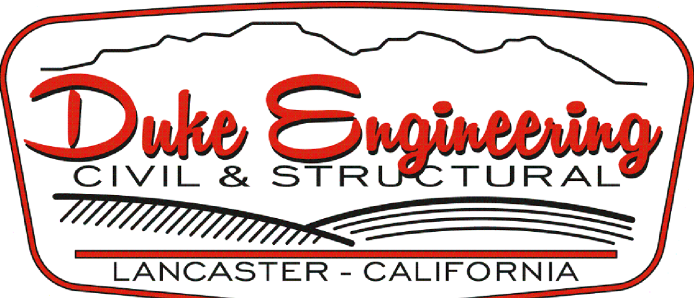

NO.	REVISION DESCRIPTION	BY	DATE	APPROVED

CHECKED BY:
SEWER IMPROVEMENTS SHOWN ARE FOR
REFERENCE ONLY. TO BE APPROVED PER
PLUMBING PLANS

CITY OF PALMDALE
SITE UTILITY PLAN
COMMERCIAL BUILDING
GRADING PLAN
APN: 3001-097-012
3007 RANCHO VISTA BLVD
PALMDALE, CA 93550
GD 21-27

SHEET
C 1.04
Project: 21041
DESIGNED: AM
DRAWN: AM
CHECKED: RD
SHEET No.
4 OF 8

GD 21-27

CITY OF PALMDALE
GRADING PLAN

EASEMENTS NOTES

- 1 — 12 FT EASEMENT FOR LANDSCAPE PURPOSES TO THE CITY OF PALMDALE
- 2 — 17 FT EASEMENT FOR STORM DRAIN & INGRESS/EGRESS PURPOSES TO THE CITY OF PALMDALE
- 3 — 10 FT EASEMENT FOR STORM DRAIN & INGRESS/EGRESS PURPOSES TO THE CITY OF PALMDALE
- 4 — 10 FT EASEMENT FOR SANITARY SEWER PURPOSES TO THE CITY OF PALMDALE
- 5 — 10 FT EASEMENT FOR WATER LINE & INGRESS/EGRESS PURPOSES TO LA COUNTY WATER WORKS

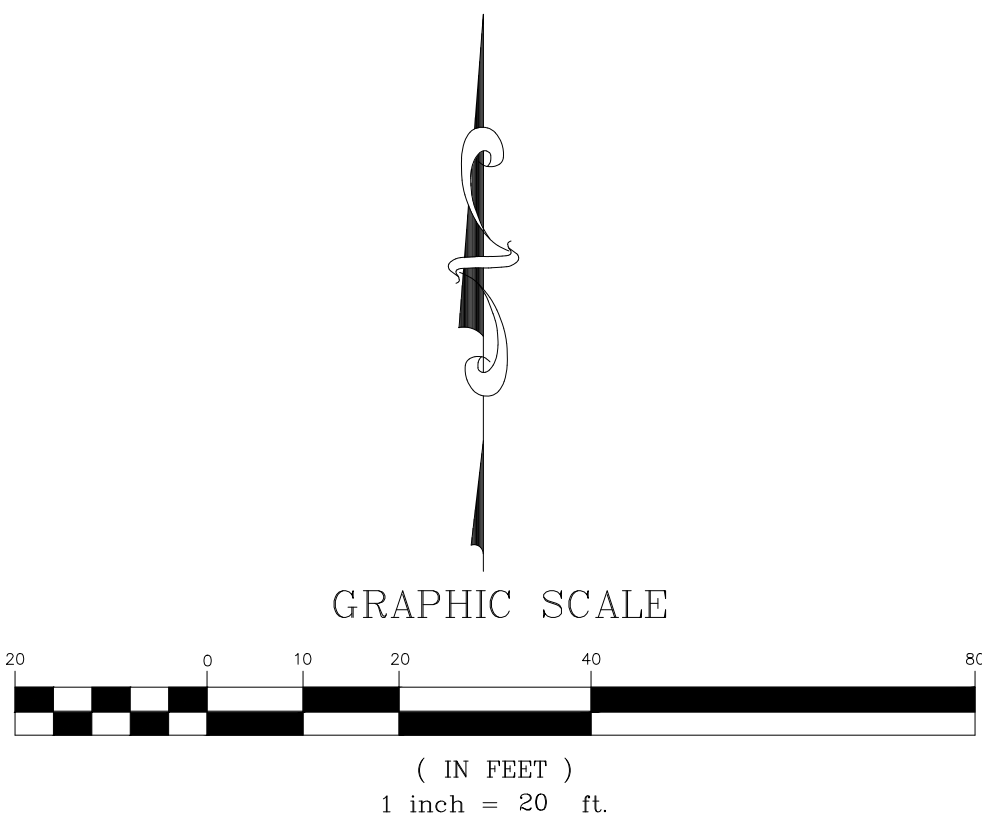
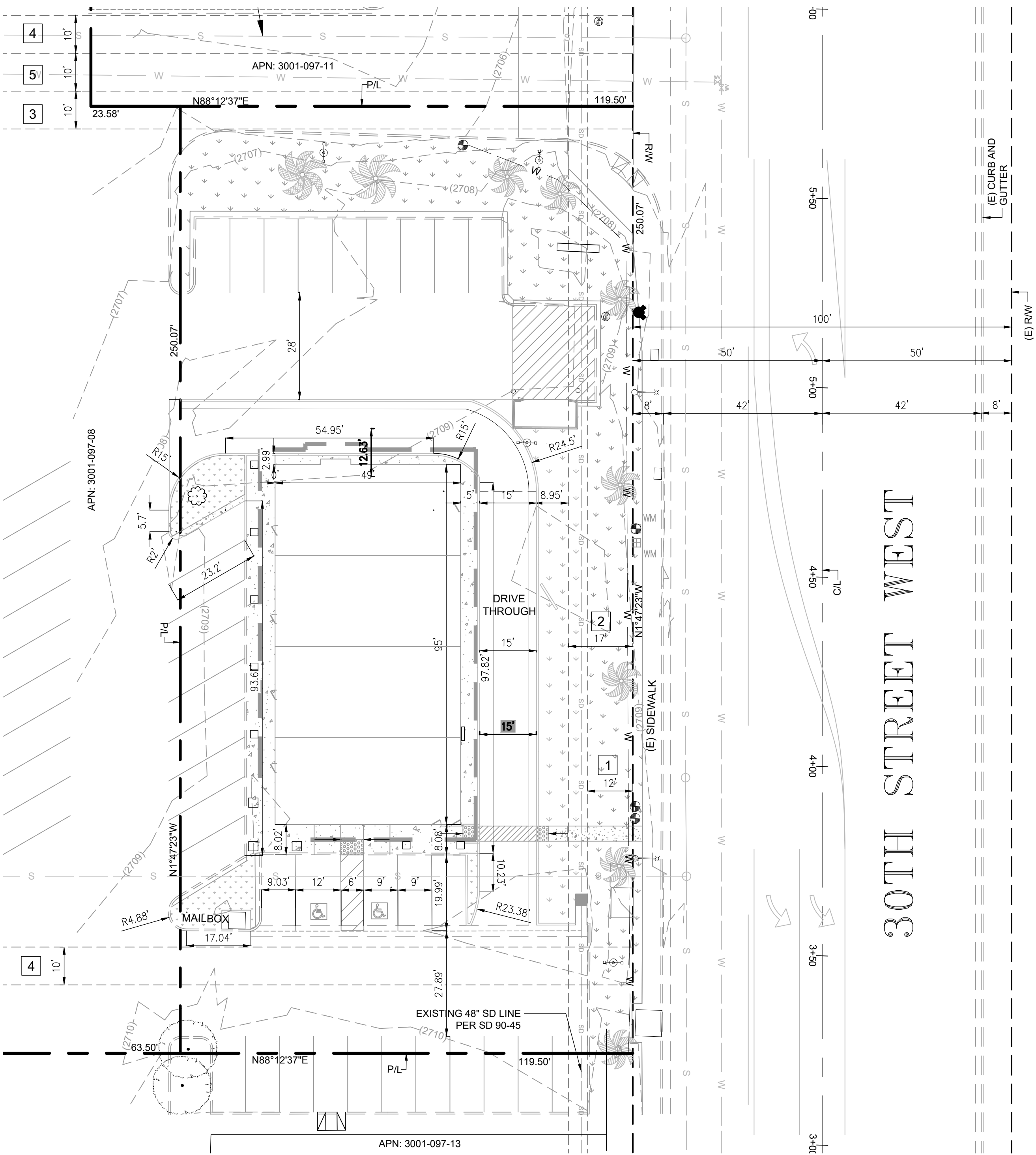

Underground Service Alert
Call: TOLL FREE
811
TWO WORKING DAYS BEFORE YOU DIG

DEVELOPER
RAMI HADDAD
44811 DATE AVE
LANCASTER CA 93534

ENGINEER OF RECORD
44732 YUCCA AVENUE
LANCASTER, CA 93534
(661) 952-7918

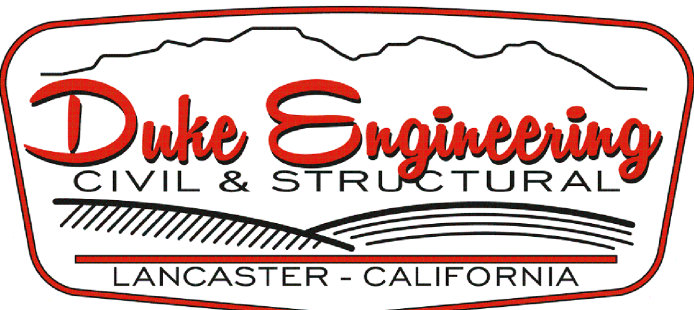

NO.	REVISION DESCRIPTION	BY	DATE	APPROVED

CHECKED BY:
PLAN CHECK ENGINEER DATE

CITY OF PALMDALE
HORIZONTAL CONTROL PLAN
COMMERCIAL BUILDING GRADING PLAN
APN: 3001-097-012
3007 RANCHO VISTA BLVD
PALMDALE, CA 93550
GD 21-27

SHEET
C 1.05
Project: 21041
DESIGNED: AM
DRAWN: AM
CHECKED: RD
SHEET No.
5 OF 8

GD 21-27

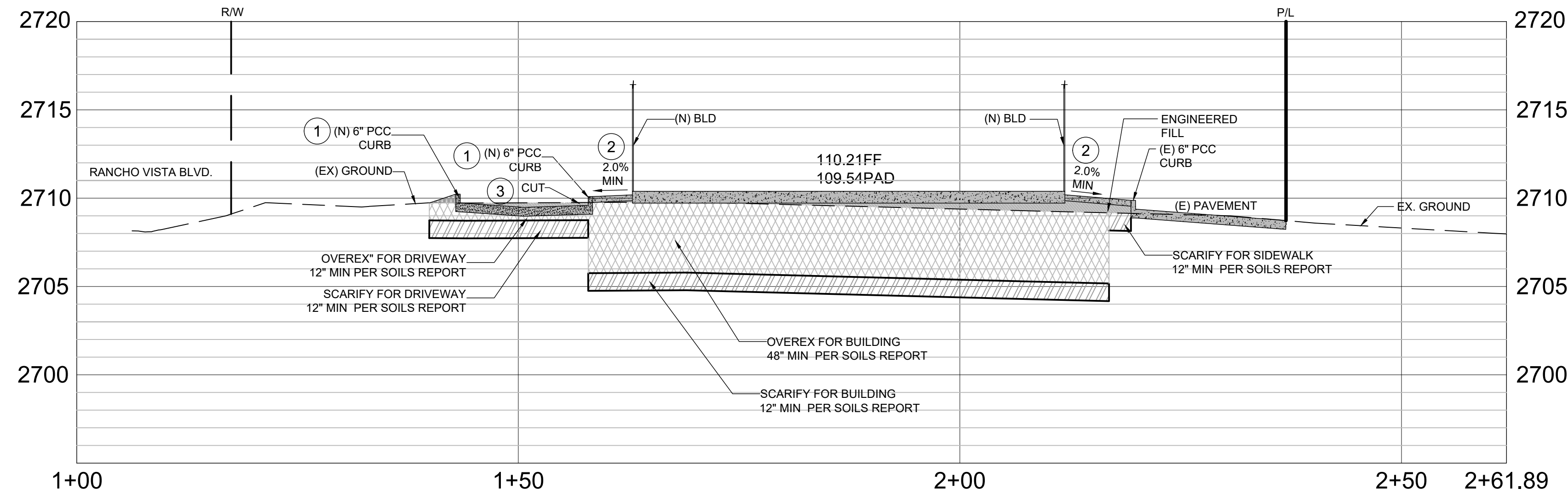

CROSS SECTION B-B

HORIZ. SCALE: 1"=10'
VERT. SCALE: 1"=4'

CONSTRUCTION NOTES:

- 1 CONSTRUCT 6" PCC CURB PER SPPWC 120-2, A1-6 (150). SEE DETAIL 'A' HEREON
- 2 CONSTRUCT 4" THICK 2500 PSI PCC CONCRETE WALKWAY PER DETAIL 'B' HEREON
- 3 CONSTRUCT 6" THICK AC PAVEMENT OVER 8" THICK AGGREGATE OVER 90% COMPACTED SUBGRADE
- 4 INSTALL ADA SIGNING AND STRIPING PER BUILDING PLANS
- 5 PROPOSED LANDSCAPE PER LSP 21-27 COM
- 6 PROPOSED MENU BOARD PER BUILDING PLANS
- 7 CONSTRUCT CURB RAMP PER SPPWC 111-5 TYPE 1 CASE A
- 8 CONSTRUCT 6" PCC CURB AND GUTTER PER SPPWC 120-2, A2-6(150). SEE DETAIL 'C' HEREON

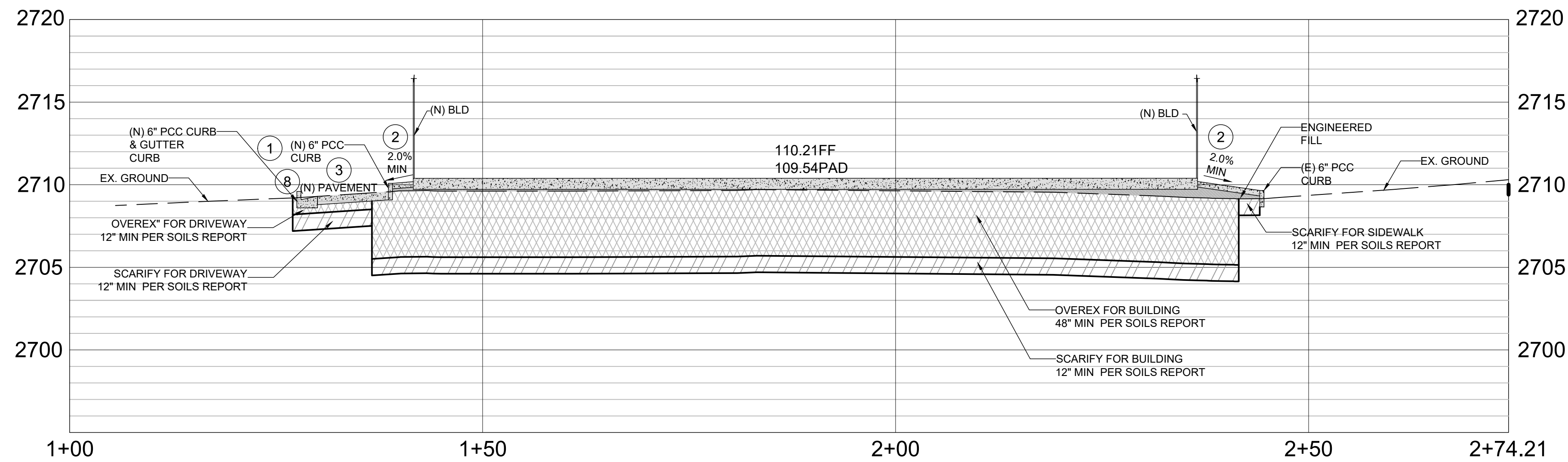

CROSS SECTION A-A

HORIZ. SCALE: 1"=10'
VERT. SCALE: 1"=4'

Underground Service Alert

Call: TOLL FREE

811

TWO WORKING DAYS BEFORE YOU DIG

DEVELOPER

RAMI HADDAD
44811 DATE AVE
LANCASTER CA 93534

ENGINEER OF RECORD
44732 YUCCA AVENUE
LANCASTER, CA 93534
(661) 952-7918

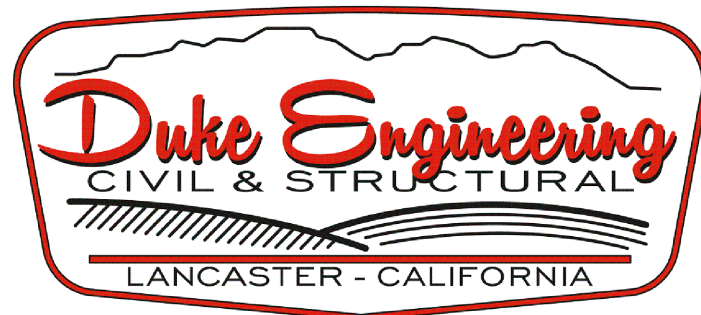

NO.	REVISION DESCRIPTION	BY	DATE	APPROVED
△				
△				
△				
△				
△				
△				

CITY OF PALMDALE		SHEET
SECTIONS		C 1.06
COMMERCIAL BUILDING GRADING PLAN APN: 3001-097-012 3007 RANCHO VISTA BLVD PALMDALE, CA 93550		Project: 21041
		DESIGNED: AM
		DRAWN: AM
CHECKED BY: PLAN CHECK ENGINEER DATE		CHECKED: RD
		SHEET No.
GD 21-27		6 OF 8

GD 21-27

STORMWATER POLLUTION PREVENTION PLAN (SWPPP) WET WEATHER EROSION CONTROL (WWECP) GENERAL NOTES:

1. IN CASE OF EMERGENCY CALL RAMI HADDAD AT (661)940-3668
2. A STAND-BY CREW FOR EMERGENCY WORK SHALL BE AVAILABLE AT ALL TIMES DURING THE RAINY SEASON (OCTOBER 1 TO APRIL 15). NECESSARY MATERIALS SHALL BE AVAILABLE ON-SITE AND STOCKPILED AT CONVENIENT LOCATIONS TO FACILITATE RAPID CONSTRUCTION OF EMERGENCY DEVICES WHEN RAIN IS IMMINENT.
3. EROSION CONTROL DEVICES SHOWN ON THIS PLAN MAY BE REMOVED WHEN APPROVED BY THE BUILDING OFFICIAL IF THE GRADING OPERATION HAS PROGRESSED TO THE POINT WHERE THEY ARE NO LONGER REQUIRED.
4. GRADED AREAS ADJACENT TO FILL SLOPES LOCATED AT THE SITE PERIMETER MUST DRAIN AWAY FROM THE TOP OF SLOPE AT THE CONCLUSION OF EACH WORKING DAY. ALL LOOSE SOILS AND DEBRIS THAT MAY CREATE A POTENTIAL HAZARD TO OFF-SITE PROPERTY SHALL BE STABILIZED OR REMOVED FROM THE SITE ON A DAILY BASIS.
5. ALL SILT AND DEBRIS SHALL BE REMOVED FROM ALL DEVICES WITHIN 24 HOURS AFTER EACH RAINSTORM AND BE DISPOSED OF PROPERLY.
6. A GUARD SHALL BE POSTED ON THE SITE WHENEVER THE DEPTH OF WATER IN ANY DEVICE EXCEEDS TWO FEET. THE DEVICE SHALL BE DRAINED OR PUMPED DRY WITHIN 24 HOURS AFTER EACH RAINSTORM. PUMPING AND DRAINING OF ALL BASINS AND DRAINAGE DEVICES MUST COMPLY WITH THE APPROPRIATE BMP FOR DEWATERING OPERATIONS.
7. THE PLACEMENT OF ADDITIONAL DEVICES TO REDUCE EROSION DAMAGE AND CONTAIN POLLUTANTS WITHIN THE SITE IS LEFT TO THE DISCRETION OF THE FIELD ENGINEER. ADDITIONAL DEVICES AS NEEDED SHALL BE INSTALLED TO RETAIN SEDIMENTS AND OTHER POLLUTANTS ON SITE.
8. DESILTING BASINS MAY NOT BE REMOVED OR MADE INOPERABLE BETWEEN OCTOBER 1 AND APRIL 15 OF THE FOLLOWING YEAR WITHOUT THE APPROVAL OF THE BUILDING OFFICIAL.
9. STORM WATER POLLUTION AND EROSION CONTROL DEVICES ARE TO BE MODIFIED, AS NEEDED, AS THE PROJECT PROGRESSES. THE DESIGN AND PLACEMENT OF THESE DEVICES IS THE RESPONSIBILITY OF THE FIELD ENGINEER. PLANS REPRESENTING CHANGES MUST BE SUBMITTED FOR APPROVAL IF REQUESTED BY THE BUILDING OFFICIAL.
10. EVERY EFFORT SHOULD BE MADE TO ELIMINATE THE DISCHARGE OF NONSTORM WATER FROM THE PROJECT SITES AT ALL TIMES.
11. ERODED SEDIMENTS AND OTHER POLLUTANTS MUST BE RETAINED ON-SITE AND MAY NOT BE TRANSPORTED FROM THE SITE VIA SHEET FLOW, SWALES, AREA DRAINS, NATURAL DRAINAGE COURSES, OR WIND.
12. STOCKPILES OF EARTH AND OTHER CONSTRUCTION-RELATED MATERIALS MUST BE PROTECTED FROM BEING TRANSPORTED FROM THE SITE BY THE FORCES OF WIND OR WATER.
13. FUELS, OILS, SOLVENTS, AND OTHER TOXIC MATERIALS MUST BE STORED IN ACCORDANCE WITH THEIR LISTING AND ARE NOT TO CONTAMINATE THE SOILS AND SURFACE WATERS. ALL APPROVED STORAGE CONTAINERS ARE TO BE PROTECTED FROM THE WEATHER. SPILLS MUST BE CLEANED UP IMMEDIATELY AND DISPOSED OF IN A PROPER MANNER. SPILLS MAY NOT BE WASHED INTO THE DRAINAGE SYSTEM.
14. EXCESS OR WASTE CONCRETE MAY NOT BE WASHED INTO THE PUBLIC RIGHT-OF-WAY OR ANY OTHER DRAINAGE SYSTEM. PROVISIONS SHALL BE MADE TO RETAIN CONCRETE WASTES ON-SITE UNTIL THEY CAN BE DISPOSED OF AS SOLID WASTE.
15. DEVELOPERS/CONTRACTORS ARE RESPONSIBLE TO INSPECT ALL EROSION CONTROL DEVICES AND ENSURE BMP'S ARE INSTALLED AND FUNCTIONING PROPERLY BEFORE AND AFTER 0.25 INCHES OR GREATER PREDICTED OR ACTUAL PRECIPITATION. A CONSTRUCTION SITE INSPECTION CHECKLIST AND INSPECTION LOG SHALL BE MAINTAINED AT THE PROJECT SITE AT ALL TIMES AND AVAILABLE FOR REVIEW BY THE BUILDING OFFICIAL (COPIES OF THE SELF-INSPECTION CHECK LIST AND INSPECTION LOGS ARE AVAILABLE UPON REQUEST).
16. TRASH AND CONSTRUCTION-RELATED SOLID WASTES MUST BE DEPOSITED INTO A COVERED RECEPTACLE TO PREVENT CONTAMINATION OF RAINWATER AND DISPERSAL BY WIND.
17. SEDIMENTS AND OTHER MATERIALS MAY NOT BE TRACKED FROM THE SITE BY VEHICLE TRAFFIC. THE CONSTRUCTION ENTRANCE ROADWAYS MUST BE STABILIZED SO AS TO INHIBIT SEDIMENTS FROM BEING DEPOSITED INTO THE PUBLIC RIGHT-OF-WAY. ACCIDENTAL DEPOSITIONS MUST BE SWEEPED UP IMMEDIATELY AND MAY NOT BE WASHED DOWN BY RAIN OR OTHER MEANS.
18. ANY SLOPES WITH DISTURBED SOILS OR DENUDED OF VEGETATION MUST BE STABILIZED SO AS TO INHIBIT EROSION BY WIND AND WATER.
19. AS THE ENGINEER OF RECORD, I HAVE SELECTED APPROPRIATE BMP'S TO EFFECTIVELY MINIMIZE THE NEGATIVE IMPACTS OF THIS PROJECT'S CONSTRUCTION ACTIVITIES ON STORM WATER QUALITY. THE PROJECT OWNER AND CONTRACTOR ARE AWARE THAT THE SELECTED BMP'S MUST BE INSTALLED, MONITORED, AND MAINTAINED TO ENSURE THEIR EFFECTIVENESS. THE BMP'S NOT SELECTED FOR IMPLEMENTATION ARE REDUNDANT OR DEEMED NOT APPLICABLE TO THE PROPOSED CONSTRUCTION ACTIVITY.

20. THE FOLLOWING BMP FROM THE "CALIFORNIA STORMWATER BMP HANDBOOK" - JANUARY 2009 AND SUBSEQUENT ERRATAS, MUST BE IMPLEMENTED FOR ALL CONSTRUCTION ACTIVITIES AS APPLICABLE.

- I. GENERAL SITE MANAGEMENT
- EC1 - SCHEDULING A010 - MATERIAL DELIVERY AND STORAGE
- EC2 - PRESERVATION OF EXISTING VEGETATION

- CONSTRUCTION PRACTICES:
- EC5 - SOIL BINDERS
- NS2 - DEWATERING OPERATIONS
- NS3 - PAVING OPERATIONS

- VEHICLE & EQUIPMENT MANAGEMENT:
- NS8 - VEHICLE AND EQUIPMENT CLEANING
- NS9 - VEHICLE AND EQUIPMENT FUELING
- NS10 - VEHICLE AND EQUIPMENT MAINTENANCE

- TRACKING CONTROL:
- TC1 - STABILIZED CONSTRUCTION ENTRANCE

- II. CONSTRUCTION MATERIAL AND WASTE MANAGEMENT
- MATERIAL MANAGEMENT:
- WM1 - MATERIAL DELIVERY AND STORAGE
- WM2 - MATERIAL USE
- WM3 - STOCKPILE MANAGEMENT
- WM4 - SPILL PREVENTION AND CONTROL

- WASTE MANAGEMENT:
- WM4 - SPILL PREVENTION AND CONTROL
- WM5 - SOLID WASTE MANAGEMENT
- WM6 - HAZARDOUS WASTE MANAGEMENT
- WM7 - CONTAMINATED SOILS MANAGEMENT
- WM8 - CONCRETE WASTE MANAGEMENT
- WM9 - SANITARY/SEPTIC WASTE MANAGEMENT
- WM10 - LIQUID WASTE MANAGEMENT

- III. EROSION CONTROL PRACTICES
- SITE PLANNING CONSIDERATIONS:
- EC1 - SCHEDULING
- EC2 - PRESERVATION OF EXISTING VEGETATION

- VEGETATIVE STABILIZATION:
- EC4 - HYDROSEED
- EC6 - MULCHING

- PHYSICAL STABILIZATION:
- EC5 - SOIL BINDERS
- EC7 - GEOTEXTILES AND MATS
- EC12 - STREAM BANK STABILIZATION
- TC1 - STABILIZED CONSTRUCTION ENTRANCE/EXIT

- FLOW CONTROL:
- EC9 - EARTH DIKE AND DRAINAGE SWALE
- EC11 - SLOPE DRAINS

- VELOCITY REDUCTION:
- EC10 - VELOCITY DISSIPATION DEVICES
- EC15 - SOIL PREPARATION-ROUGHENING
- SE4 - CHECK DAMS

- IV. SEDIMENT CONTROL:
- SE1 - SILT FENCE
- SE2 - SEDIMENT BASIN
- SE3 - SEDIMENT TRAP
- SE8 - SAND BAG BARRIER
- SE9 - STRAW BALE BARRIERS
- SE10 - STORM DRAIN INLET PROTECTION
- SE14 - BIOFILTER BAGS

*THE ABOVE NOTES AND BMP'S AS OUTLINED IN, BUT NOT LIMITED TO, THE BMP HANDBOOK, CALIFORNIA STORMWATER QUALITY TASK FORCE, SACRAMENTO, CALIFORNIA JANUARY 2009 AND SUBSEQUENT ERRATAS, OR THE LATEST REVISED EDITION, MAY APPLY DURING THE CONSTRUCTION OF THIS PROJECT (ADDITIONAL MEASURES MAY BE REQUIRED IF DEEMED APPROPRIATE BY COUNTY INSPECTORS).

MINIMUM BMP'S:

THE NATIONAL POLLUTANT DISCHARGE ELIMINATION SYSTEM (NPDES) IS THE PORTION OF THE CLEAN WATER ACT THAT APPLIES TO THE PROTECTION OF RECEIVING WATERS. UNDER PERMITS FROM THE LOS ANGELES REGIONAL WATER QUALITY CONTROL BOARD (RWQCB), CERTAIN ACTIVITIES ARE SUBJECT TO RWQCB ENFORCEMENT. TO MEET THE REQUIREMENTS OF THE LOS ANGELES COUNTY MUNICIPAL STORMWATER PERMIT (CAS004001), MINIMUM REQUIREMENTS FOR SEDIMENT CONTROL, EROSION CONTROL AND CONSTRUCTION ACTIVITIES MUST BE IMPLEMENTED ON EACH PROJECT SITE. MINIMUM REQUIREMENTS INCLUDE:

SEDIMENT CONTROL: ERODED SEDIMENTS FROM AREAS DISTRIBUTED BY CONSTRUCTION AND FROM STOCKPILES OF SOIL SHALL BE RETAINED ON SITE TO MINIMIZE SEDIMENT TRANSPORT FROM THE SITE TO STREETS, DRAINAGE FACILITIES OR ADJACENT PROPERTIES VIA RUNOFF, VEHICLE TRACKING OR WIND.

WET WEATHER EROSION CONTROL PLAN (WWECP) IS REQUIRED DURING THE WET SEASON (OCTOBER 1ST - APRIL 15TH).

HILLSIDE: CONSTRUCTION UPON SLOPES 25% OR MORE REQUIRES THE IMPLEMENTATION OF ADDITIONAL BMPS TO PROTECT SLOPES AND PREVENT EROSION AND SEDIMENT RUNOFF.

CONSTRUCTION MATERIALS CONTROL:CONSTRUCTION RELATED MATERIALS, WASTES, SPILLS OR RESIDUES SHALL BE RETAINED ON SITE TO MINIMIZE TRANSPORT FROM THE SITE TO STREETS, DRAINAGE FACILITIES OR ADJOINING PROPERTIES BY WIND OR RUNOFF. RUNOFF FROM EQUIPMENT AND VEHICLE WASHING SHALL BE CONTAINED AT CONSTRUCTION SITES UNLESS TREATED TO REMOVE SEDIMENT AND POLLUTANTS.

NON STORMWATER RUNOFF: NON-STORMWATER RUNOFF FROM EQUIPMENT AND VEHICLE WASHING AND ANY OTHER ACTIVITY SHALL BE CONTAINED AT THE PROJECT SITE.

EROSION: EROSION FROM SLOPES AND CHANNELS SHALL BE CONTROLLED BY IMPLEMENTING AN EFFECTIVE COMBINATION OF BMPS (AS APPROVED IN REGIONAL BOARD RESOLUTION NO. 99-03), SUCH AS THE LIMITING OF GRADING SCHEDULE DURING DURING THE WET SEASON; INSPECTING GRADING AREAS DURING RAIN EVENTS; PLANTING AND MAINTENANCE OF VEGETATION ON SLOPES; AND COVERING EROSION SUSCEPTIBLE SLOPES.

(1) SOIL PILES MUST BE COVERED WITH TARPS PR PLASTIC, (2) LEAKING EQUIPMENT MUST BE REPAIRED IMMEDIATELY, (3) REFUELING MUST BE CONDUCTED AWAY FROM CATCH BASINS, (4) CATCH BASINS MUST BE PROTECTED WHEN WORKING NEARBY, (5) VACUUM ALL CONCRETE SAW CUTTING, (6) NEVER WASH CONCRETE WASTE INTO THE STREET, (7) KEEP SITE CLEAN, SWEEP THE GUTTERS AT THE END OF EACH WORKING DAY AND KEEP A TRASH RECEPTACLE ON SITE.

EROSION CONTROL NOTES:

1. IN CASE OF EMERGENCY CALL RAMI HADDAD (661) 940-3668
2. A STANDBY CREW FOR EMERGENCY WORK SHALL BE AVAILABLE AT ALL TIMES. NECESSARY MATERIALS SHALL BE AVAILABLE ON-SITE AND STOCKPILED AT CONVENIENT LOCATIONS TO FACILITATE RAPID CONSTRUCTION OF TEMPORARY DEVICES OR TO REPAIR ANY DAMAGED EROSION CONTROL MEASURES.
3. EROSION CONTROL DEVICES SHALL NOT BE MOVED OR MODIFIED WITHOUT THE APPROVAL OF THE CITY ENGINEER.
4. ALL REMOVABLE PROTECTIVE DEVICES SHOWN SHALL BE IN PLACE AT THE END OF EACH WORKING DAY IN THE PERIOD FROM OCTOBER 1 THROUGH APRIL 15, AND AT ANY OTHER PERIOD WHEN THE WEATHER FORECAST INDICATES A GREATER THAN 50% PROBABILITY OF RAIN.
5. AFTER A RAINSTORM, ALL SILT AND DEBRIS SHALL BE REMOVED FROM CHECK BERMS AND DESILTING BASINS. ANY GRADED SLOPE SURFACE PROTECTION MEASURES DAMAGED DURING THE RAINSTORM SHALL ALSO BE REPAIRED IMMEDIATELY.
6. FILL SLOPES AT THE PROJECT PERIMETER MUST DRAIN AWAY FROM THE TOP OF THE SLOPE AT THE CONCLUSION OF EACH WORKING DAY.
7. A SIX-FOOT HIGH PERIMETER FENCE OR A 24-HOUR GUARD SHALL BE POSTED ON THE SITE WHENEVER THE DEPTH OF WATER IN ANY DEVICE EXCEEDS 18 INCHES.
8. THE ENGINEER OF RECORD IS RESPONSIBLE FOR ASSURING THE ACCURACY AND ACCEPTABILITY OF THE WORK. IN THE EVENT OF DISCREPANCIES ARISING DURING CONSTRUCTION, THE ENGINEER OF RECORD SHALL BE RESPONSIBLE FOR DETERMINING AN ACCEPTABLE SOLUTION AND REVISING THE PLANS FOR APPROVAL BY THE CITY.
9. TEMPORARY EROSION DEVICES SHOWN ON THE GRADING PLAN WHICH INTERFERE WITH THE WORK SHALL BE RELOCATED OR MODIFIED WHEN THE PUBLIC WORKS INSPECTOR SO DIRECTS THE WORK PROGRESS.
10. ALL LOOSE SOIL AND DEBRIS SHALL BE REMOVED FROM THE STREET AREAS UPON STARTING OPERATIONS AND PERIODICALLY THEREAFTER AS DIRECTED BY THE PUBLIC WORKS INSPECTOR.
11. WHEN THE PUBLIC WORKS INSPECTOR SO DIRECTS, A 12-INCH BERM SHALL BE MAINTAINED ALONG THE TOP OF THE SLOPE OF THOSE FILLS ON WHICH GRADING IS NOT IN PROGRESS.
12. VELOCITY CHECK DAMS SHALL BE PROVIDED ACROSS THE OUTLETS OF ALL LOTS DRAINING INTO THE STREET.
13. ALL FILLS SHALL BE GRADED TO PROMOTE DRAINAGE AWAY FROM THE EDGE OF THE FILL.
14. STAND-BY CREWS SHALL BE ALERTED BY THE PERMITTEE OR CONTRACTOR FOR EMERGENCY WORK DURING RAINSTORMS.
15. ALL UTILITY TRENCHES SHALL BE BLOCKED AT THE PRESCRIBED INTERVALS FROM BOTTOM TO TOP WITH A DOUBLE ROW OF SANDBAGS PRIOR TO BACKFILL. SEWER TRENCHES SHALL BE BLOCKED AT THE PRESCRIBED INTERVALS WITH A DOUBLE ROW OF SANDBAGS EXTENDING DOWNWARD, TWO SANDBAGS FROM THE GRADED SURFACE OF THE STREET. SANDBAGS ARE TO BE PLACED WITH

alternate header and stretcher courses. The intervals prescribed between sandbag blocking shall depend on the slope of the ground surface, but not exceed the following:

GRADE OF THE STREET	INTERVALS
LESS THAN 2%	AS REQUIRED
2% TO 5%	100 FEET
4% TO 10%	50 FEET
OVER 10%	25 FEET

16. Velocity check dams shall be provided in all unpaved street indicated above. Velocity check dams may be constructed of areas at the intervals other erosion-resistant materials approved by the Public Works sandbags, timber, or extend completely across the street or channel at right angles to inspector, and shall Earth dikes may not be used as velocity check dams. Plastic bags the centerline. for sandbags. shall not be used

17. Velocity check dams shall be provided in all unpaved graded intervals indicated below: channels at the

GRADE OF THE CHANNEL	INTERVALS BETWEEN CHECK DAMS
LESS THAN 3%	AS REQUIRED
3% TO 6%	100 FEET
OVER 6%	50 FEET
	25 FEET

18. After sewer and utility trenches are backfilled and compacted, the surfaces over such trenches shall be mounded slightly to prevent channeling of water in the trench area. Care should be exercised to provide for cross flows at frequent intervals where trenches are not on the centerline of a crown street.

19. Except when the Public Works Inspector directs otherwise, all devices shown shall be in place at the end of each working day when rain is forecast and shall be maintained during the rainy season (October 1 thru April 15).

20. All basins and check dams shall have the debris and silt removed after each storm to restore their capacity.

21. Sandbag shall be stockpiled in parkway at intervals shown plans, ready to be placed

in position when rain is forecast, or when the Public Works Inspector so directs.

22. Brush and ground cover may not be removed more than 10-feet above fills between October 1 and April 15.

23. Placement of devices to reduce erosion damage within the project must be shown on the plan.

Stockpile locations for materials shall also be indicated on the drawing.

24. Outlet conditions from the desilting basin shall not exceed downstream limitations. The overflow shall be designed to safely pass 1.5 times the 25-year peak discharge.

25) A CONSTRUCTION ENTRANCE SHALL BE INSTALLED PRIOR TO COMMENCEMENT OF GRADING. LOCATION OF THE ENTRANCE MAY BE ADJUSTED BY THE CONTRACTOR TO FACILITATE GRADING OPERATIONS. ALL CONSTRUCTION TRAFFIC ENTERING THE PAVED ROAD MUST CROSS THE CONSTRUCTION ENTRANCE. THE CONSTRUCTION ENTRANCE SHALL CONSIST OF A BED OF 3/4" GRAVEL OF THE FOLLOWING MINIMUM DIMENSIONS: 15' WIDE, 30' LONG AND 12" DEEP. THE CONSTRUCTION ENTRANCE SHALL BE REMOVED PRIOR TO PLACING BASE FOR PAVING.

26) ALL SANDBAGS SHALL BE AMERICAN BUILDERS SUPPLY SIZE 18"x 30"MADE OF PROPYLENE MATERIAL OR EQUAL, WITH 10X12 WEAVE, 950 DENIER, 1200-HOUR U.V. RATING, OF MILK WHITE COLOR, AND SHOULD HAVE 1000 PER BALE.

27) SEDIMENTS AND OTHER POLLUTANTS MUST BE RETAINED ON SITE AND MAY NOT BE TRANSPORTED FROM THE SITE VIA SHEET FLOW, SWALES, AREA DRAINS, NATURAL DRAINAGE COURSES OR WIND.

28) STOCKPILES OF EARTH AND OTHER CONSTRUCTION RELATED MATERIALS MUST BE PROTECTED FROM BEING TRANSPORTED FROM THE SITE BY THE FORCES OF WIND OR WATER.

29) FUELS, OILS, SOLVENTS AND OTHER TOXIC MATERIALS MUST BE STORED IN ACCORDANCE WITH THEIR LISTING AND ARE NOT TO CONTAMINATE THE SOIL AND SURFACE WATERS. ALL APPROVED STORAGE CONTAINERS ARE TO BE PROTECTED FROM THE WEATHER. SPILLS MUST BE CLEANED UP IMMEDIATELY AND DISPOSED OF IN A PROPER MANNER. SPILLS MAY NOT BE WASHED INTO THE DRAINAGE SYSTEM.

30) NON-STORM WATER RUNOFF FROM EQUIPMENT AND VEHICLE WASHING AND ANY OTHER ACTIVITY SHALL BE CONTAINED AT THE PROJECT SITE.

- 31) EXCESS OR WASTE CONCRETE MAY NOT BE WASHED INTO THE PUBLIC WAY OR ANY OTHER DRAINAGE SYSTEM. PROVISIONS SHALL BE MADE TO RETAIN CONCRETE WASTES ON SITE UNTIL THEY CAN BE DISPOSED OF AS SOLID WASTE.
- 32) TRASH AND CONSTRUCTION RELATED SOLID WASTES MUST BE DEPOSITED INTO A COVERED RECEPTACLE TO PREVENT CONTAMINATION OF RAINWATER AND DISPERSAL BY WIND.
- 33) SEDIMENTS AND OTHER MATERIALS MAY NOT BE TRACKED FROM THE SITE BY VEHICLE TRAFFIC. THE CONSTRUCTION ENTRANCE ROADWAYS MUST BE STABILIZED SO TO INHIBIT SEDIMENTS FROM BEING DEPOSITED INTO THE PUBLIC WAY. ACCIDENTAL DEPOSITIONS MUST BE SWEEPED UP IMMEDIATELY AND MAY NOT BE WASHED DOWN BY RAIN OR OTHER MEANS.
- 34) ANY SLOPES WITH DISTURBED SOILS OR DENUDED OF VEGETATION MUST BE STABILIZED SO AS TO INHIBIT EROSION BY WIND AND WATER.

CIVIL ENGINEERS' SIGNATURE

2/7/2022
DATE

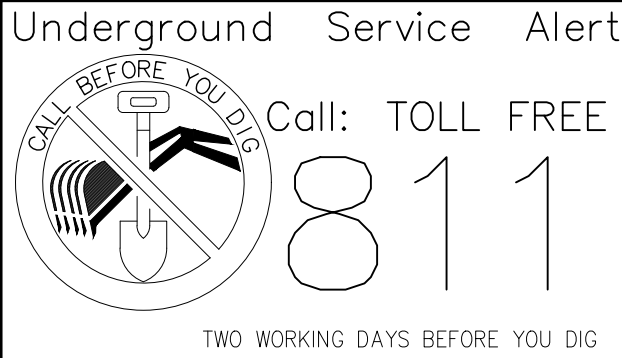

DEVELOPER
RAMI HADDAD
44811 DATE AVE
LANCASTER CA 93534

ENGINEER OF RECORD
44732 YUCCA AVENUE
LANCASTER, CA 93534
(661) 952-7918

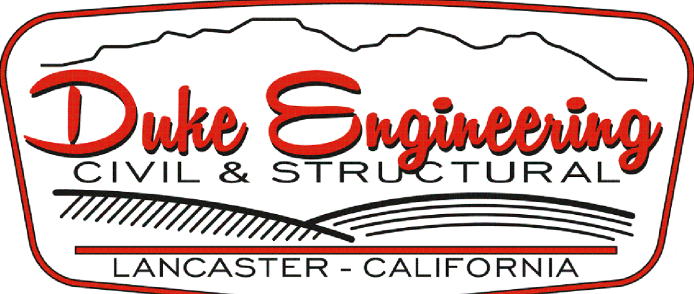

NO.	REVISION DESCRIPTION	BY	DATE	APPROVED
△				
△				
△				
△				
△				
△				

CHECKED BY:

PLAN CHECK ENGINEER

DATE

CITY OF PALMDALE		SHEET C 1.07
EROSION CONTROL COVER		
COMMERCIAL BUILDING GRADING PLAN APN: 3001-097-012 3007 RANCHO VISTA BLVD PALMDALE, CA 93550		DESIGNED: AM DRAWN: AM CHECKED: RD
		SHEET No.
GD 21-27		7 OF 8

GD 21-27

CITY OF PALMDALE
EROSION CONTROL PLAN

EROSION CONTROL CONSTRUCTION NOTES:

- 1 INSTALL GRAVEL BAGS PER DETAIL 2 HEREON. (BMP SE-4)
- 2 CONSTRUCT ENTRANCE/OUTLET TIRE WASH PER DETAIL 1 HEREON. (BMP TC-2)
- 3 IF APPLICABLE STREET SWEEPING PER BMP SE-7.
- 4 PROPOSED VEHICLE EQUIPMENT AREA FOR CLEANING, FUELING AND MAINTENANCE. FOLLOW BMP'S WM4 AND WM10 FOR SPILL PREVENTION AND CONTROLS, AS NECESSARY.
- 5 PROPOSED MATERIAL DELIVERY AND STORAGE AREA. FOLLOW BMP'S WM4 AND WM10 FOR SPILL PREVENTION AND CONTROLS, AS NECESSARY.
- 6 PROPOSED WASTE COLLECTION AREA, AS NECESSARY.
- 7 PROPOSED CONCRETE TRUCK WASHOUT AREA. FOLLOW BMP WM8 FOR WASTE CONTROLS, AS NECESSARY.
- 8 INSTALL PROPOSED SILT FENCE PER DETAIL 3 HEREON AND SE-1. SWPPP NOTE 1: SILT FENCE PERIMETER BMP MAY BE SUBSTITUTED WITH PROPERLY EMBEDDED FIBER ROLL (SEW-5) AT DISCRETION OF QSP.

SILT FENCE NOTES:

1. CONSTRUCT SILT FENCE ALONG A LEVEL CONTOUR.
2. WHEN STANDARD STRENGTH FILTER FABRIC IS USED A WIRE MESH SUPPORT FENCE SHALL BE FASTENED TO THE UPSLOPE SIDE OF THE POSTS USING HEAVY- DUTY WIRE STAPLES ARE LEAST 1" LONG TIE WIRES OR HOG RINGS. THE WIRE SHALL EXTEND INTO THE TRENCH A MINIMUM OF 4".
3. STANDARD STRENGTH FILTER FABRIC SHALL BE STAPLED OR WIRED TO THE FENCE AND 40" OF THE FABRIC SHALL EXTEND INTO THE TRENCH. WHEN EXTRA-STRENGTH FILTER FABRIC AND CLOSER POST SPACING ARE USED THE WIRE MESH SUPPORT FENCE MAY BE ELIMINATED AND THE FILTER FABRIC STAPLED OR WIRED DIRECTLY TO THE POSTS.
4. FILTER FABRIC SHALL BE PURCHASED IN A CONTINUOUS ROLL THEN CUT TO THE LENGTH OF THE BARRIER. WHEN JOINTS ARE NECESSARY FILTER CLOTH SHALL BE SPICED TOGETHER ONLY TO A SUPPORT POST WITH A MINIMUM 6" OVERLAP AND BOTH AND SECURELY FASTENED TO THE POST.
5. THE TRENCH SHALL BE BACKFILLED WITH IMPACTED NATIVE MATERIAL.
6. IF 85% OR MORE OF A SOIL BY WEIGHT PASSES THROUGH THE OPENINGS IN A NO. 200 SIEVE (U.S. STANDARD) FILTER FABRIC SHALL NOT BE USED.
7. FILTER FABRIC MATERIAL SHALL CONTAIN ULTRAVIOLET RAY INHIBITORS AND STABILIZERS TO PROVIDE A MINIMUM OF 6 MONTHS OF EXPECTED USABLE CONSTRUCTION LIFE AT A TEMPERATURE RANGE OF 0 DEGREES FAHRENHEIT TO 120 DEGREES FAHRENHEIT.
8. SILT FENCES SHALL REMAIN IN PLACE UNTIL THE SLOPED AREA IS PERMANENTLY STABILIZED.
9. LEAVE AN UNDISTURBED OR STABILIZED AREA IMMEDIATELY DOWNSLOPE FROM THE FENCE.

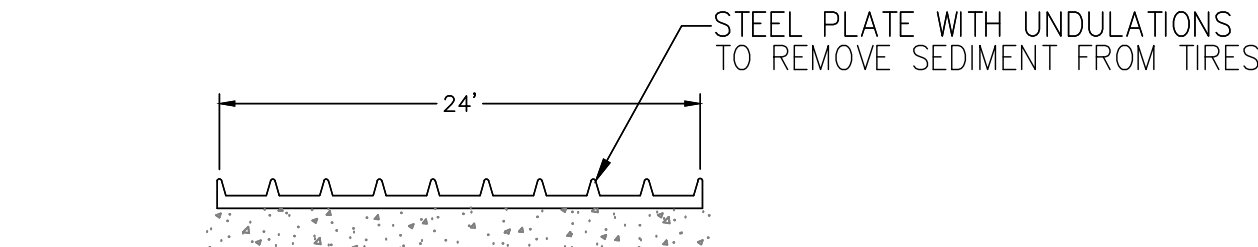
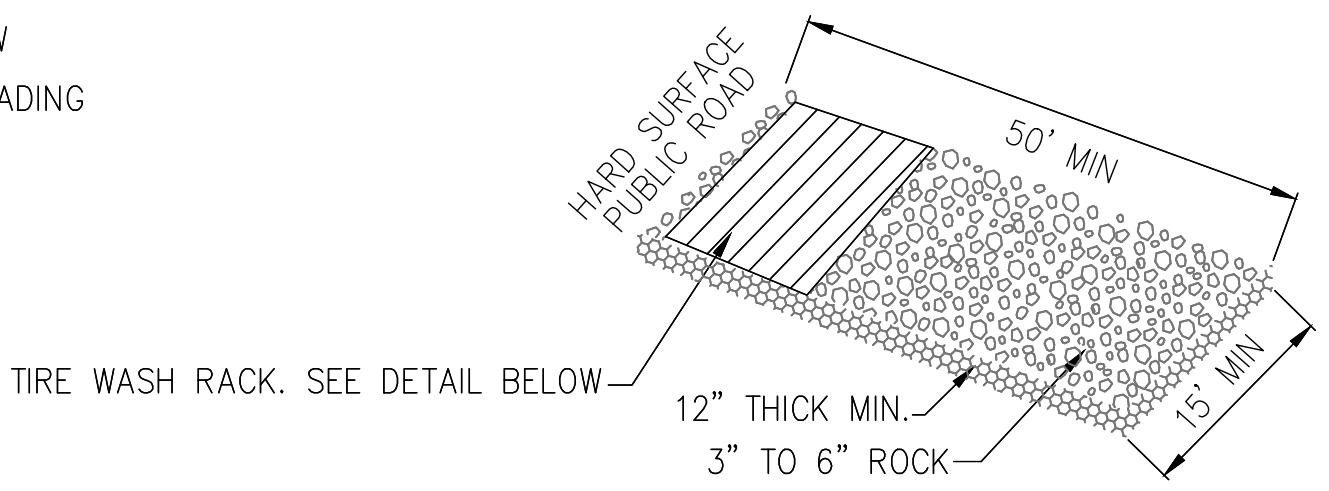

1 ENTRANCE/OUTLET TIRE WASH
N.T.S.

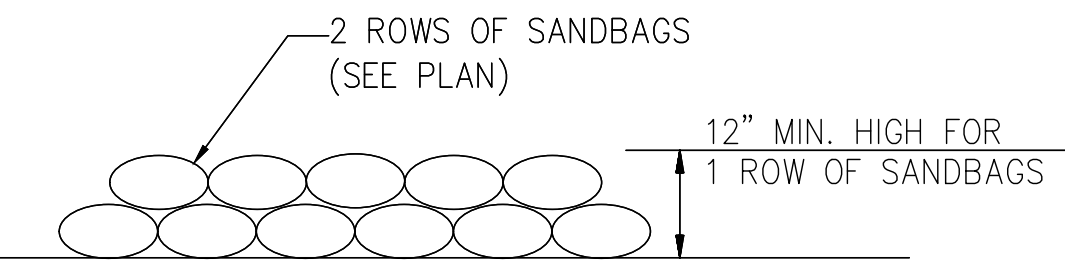

2 GRAVEL BAGGING DETAIL
N.T.S.

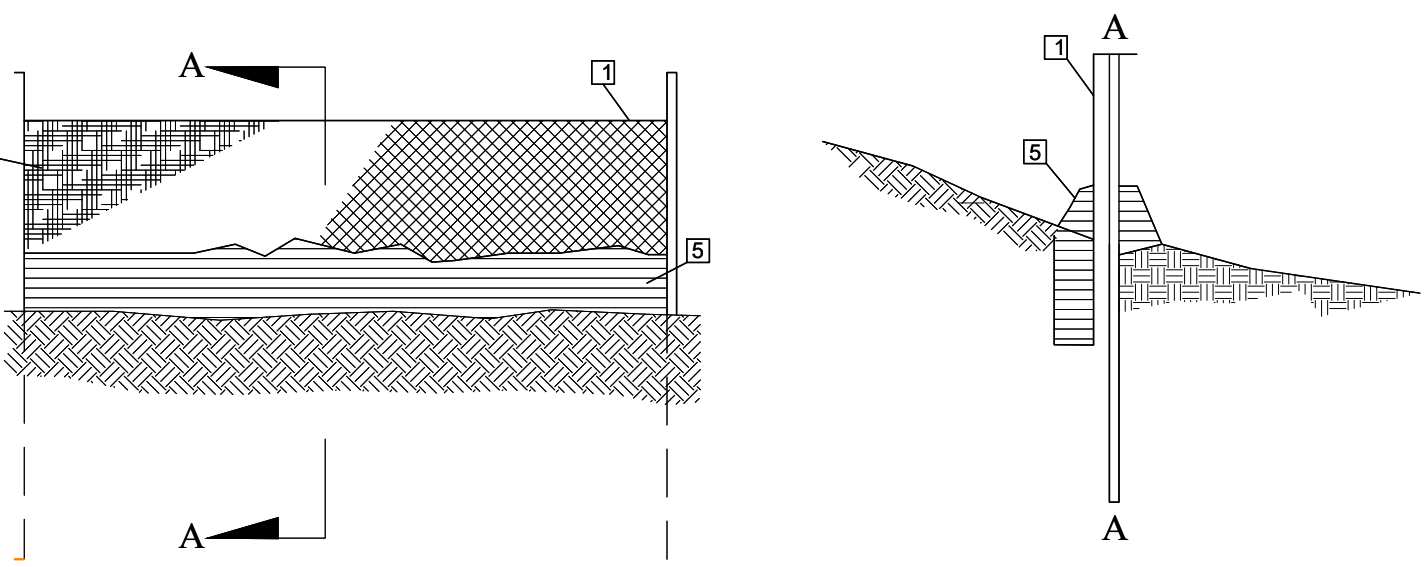

3 SILT FENCE DETAIL
N.T.S.

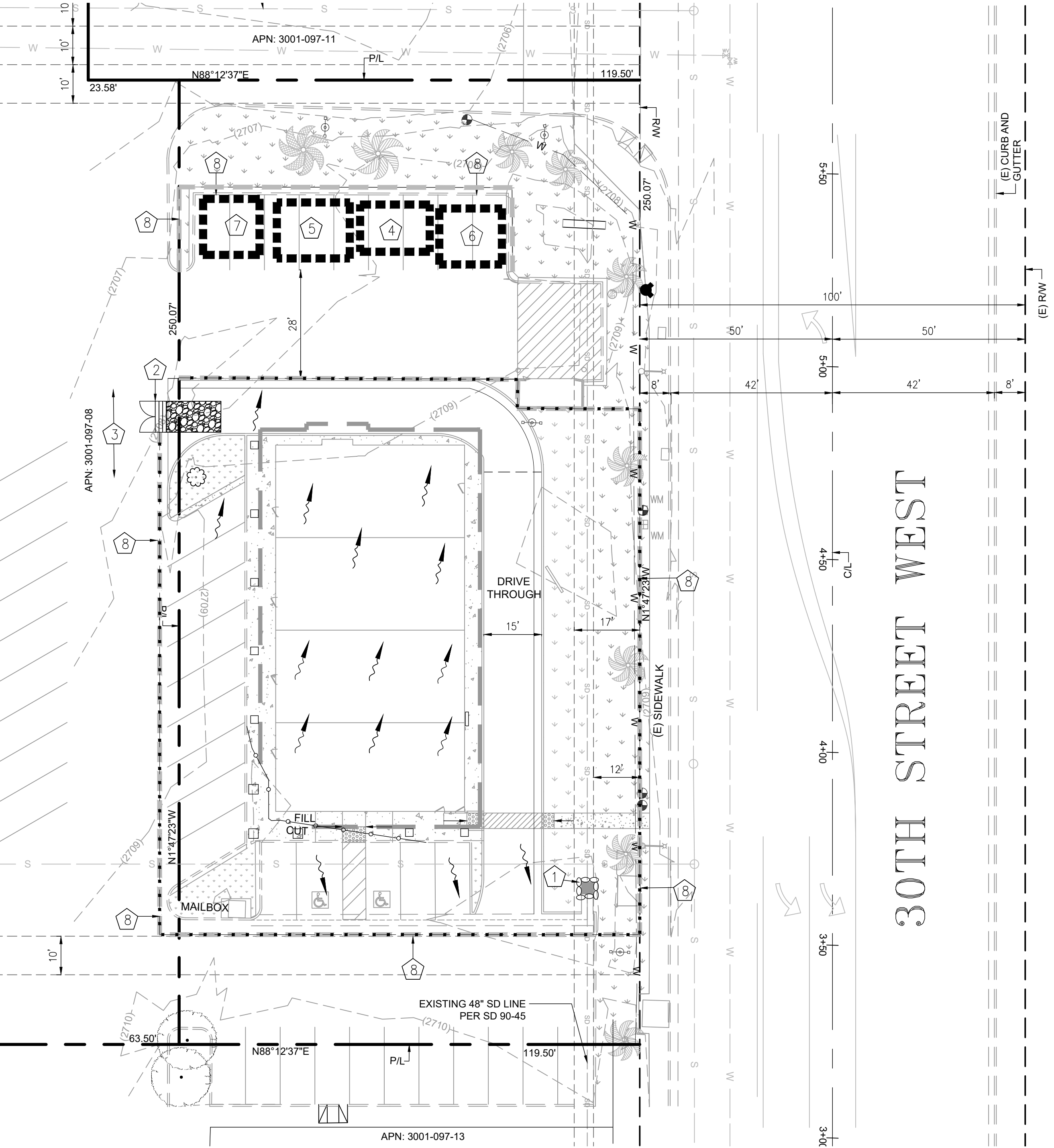
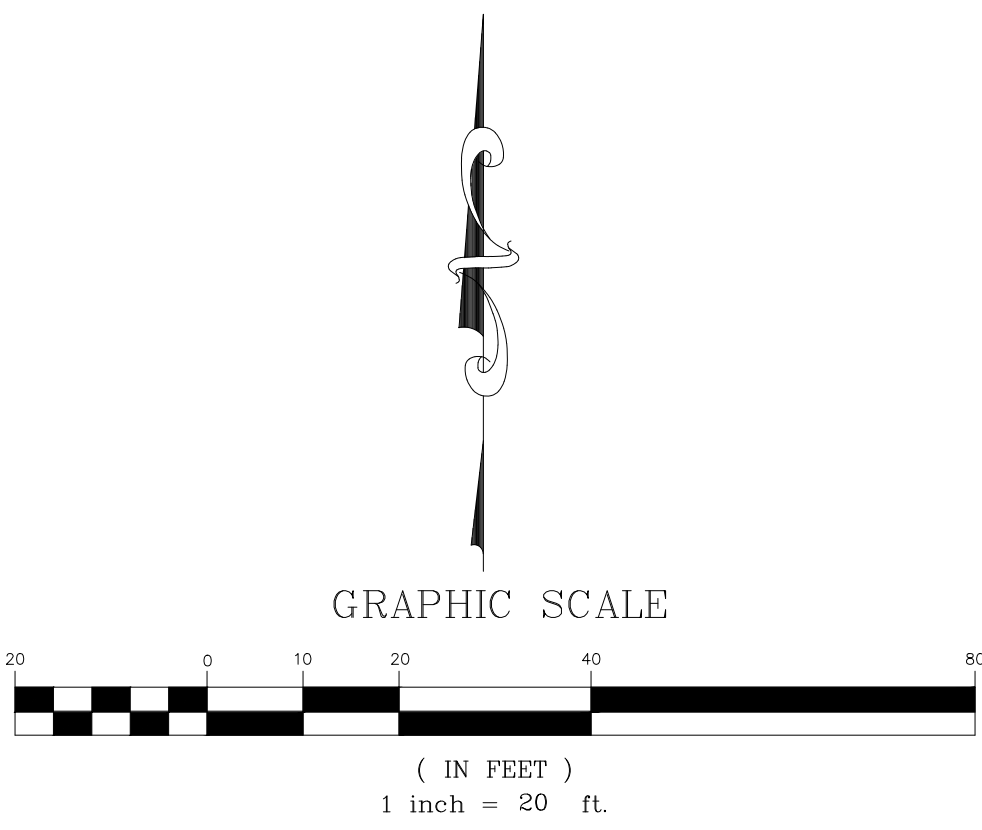

Underground Service Alert
Call: TOLL FREE
811
TWO WORKING DAYS BEFORE YOU DIG

DEVELOPER
RAMI HADDAD
44811 DATE AVE
LANCASTER CA 93534

ENGINEER OF RECORD
44732 YUCCA AVENUE
LANCASTER, CA 93534
(661) 952-7918

Duke Engineering
CIVIL & STRUCTURAL
LANCASTER - CALIFORNIA

							CITY OF PALMDALE		SHEET
							EROSION CONTROL PLAN		C 1.08
							Project: 21041		
NO.	REVISION DESCRIPTION	BY	DATE	APPROVED			COMMERCIAL BUILDING GRADING PLAN		DESIGNED: AM
△							APN: 3001-097-012		DRAWN: AM
△							3007 RANCHO VISTA BLVD		CHECKED: RD
△							PALMDALE, CA 93550		SHEET No.
△									8 OF 8
△									
△					PLAN CHECK ENGINEER	DATE	GD 21-27		